

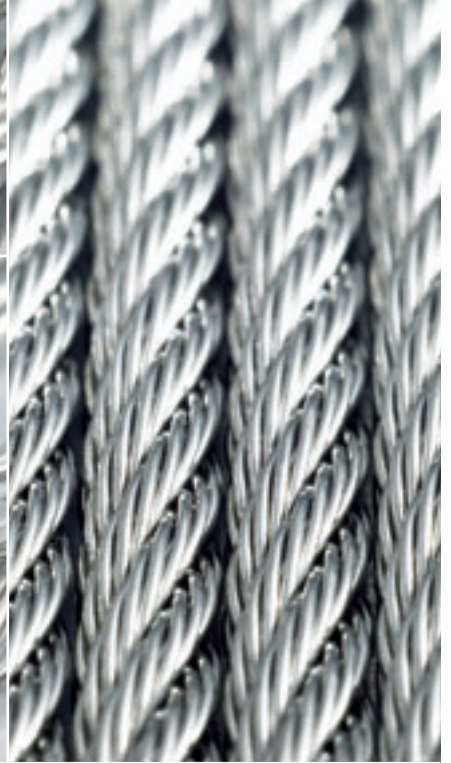

I-SYS



I-SYS





Carl Stahl is one of the leading manufacturers of cable and hoist technology in the world. The specialist company from Germany is constantly opening up new horizons with consistently thought-through applications and first-class quality. Willy Schwenger – owner and guiding spirit – and Wolfgang Funk manage the family-run concern together with the next generation, Andreas Urbez and Wolfgang Schwenger. Almost 700 employees all over the world are building the future of this dynamic medium-sized company.

Corporate vision, far-sightedness and identification with the needs of customers are among the secrets of the company's success. Both release innovative and creative forces. Classical applications in mechanical engineering, the construction industry and shipbuilding are today complemented by new high-tech sectors - from medical technology through to automotive manufacturing.

The most recent and unusual areas of activity within the company include development and design of stainless steel cables and stainless steel cable mesh for architectural applications. Two ranges mark the creative strengths of the cable manufacturers from Suessen: X-TEND, the mesh made of stainless steel cables, and I-SYS, the many-sided stainless steel architecture range.



I-SYS: Expertise and Creativity	6
I-SYS: Advice and Planning	8
External Threads	10
Internal Threads	22
Forks	30
Eyes	44
End Stops	56
Cables Loops Clamps Accessories	66
I-SYS: Greenery	86
I-SYS: Canopy	96
I-SYS: Balustrade	98
Assured Safety	102
Technology	104
Dimensions	106
Key	107
Carl Stahl: Product Range	108
Carl Stahl: Worldwide	110



I-SYS: Expertise and Creativity

I-SYS, the stainless steel architectural range, transforms visions into reality. I-SYS offers both form and function to the architect, with a superb range of literally thousands of components and assemblies. I-SYS products can be used for many applications from small decorative projects to high load cables for tensile structures.

I-SYS offers functionality, consistent quality, creativity of application and prize winning design. General planning authority approval of many components, successful test programs and a number of company patents typify the professionalism of the range. Stainless steel material allows durable, cost effective and low maintenance solutions to be created. I-SYS sets worldwide standards of modern construction for architects, engineers and fabricators.



I-SYS: Advice and Planning



I-SYS includes components, combinations and individual applications. Above all, I-SYS constitutes an invitation to cooperative action. The experts from Carl Stahl offer advice and plan small and large projects, they inspire architects to find the most aesthetically satisfying solutions and supply statics calculations. A service which is as rapid as it is professional and which is in demand all over the world. The range of expertise of our specialists ranges from the first idea, through truly exceptional development, up to manufacture, assembly and subsequent service.





I-SYS: External Threads

Stainless steel cables are turned into universal elements by means of useful connectors, fittings and guides. They have to be strong in order to take up the forces which occur and at the same time they must harmonise with the architecture. A performance which the individual components of I-SYS negotiate with the greatest of ease. Including the jewel in the crown, the F50, a hammered external thread which brings together different diameters of stainless steel cable and final connectors in a perfect interference fit.



External thread F50 hammered

Part number RH thread	Part number LH thread	ø rope	a	b	c	ø d	kN
950-0400-30	951-0400-30	4	M4	55	30	4,4	5,3
950-0400-60	951-0400-60	4	M4	85	60	4,4	5,3
950-0500-30	951-0500-30	5	M5	60	30	5,5	8,4
950-0500-60	951-0500-60	5	M5	90	60	5,5	8,4
950-0600-30	951-0600-30	6	M6	66	30	6,6	12,1
950-0600-60	951-0600-60	6	M6	96	60	6,6	12,1
950-0800-30	951-0800-30	8	M8	90	30	8,8	21,5
950-0800-60	951-0800-60	8	M8	120	60	8,8	21,5

Material 1.4404 | Not suitable for strands

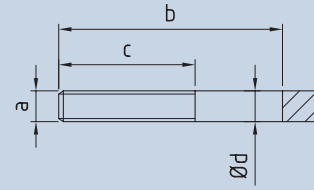

External thread F30 hammered

Part number RH thread	Part number LH thread	ø rope	a	b	c	ø d	kN
948-0300-20	949-0300-20	3	M4	37	20	3,9	4
948-0300-40	949-0300-40	3	M4	57	40	3,9	4
948-0400-30	949-0400-30	4	M5	50	30	4,9	7,1
948-0400-50	949-0400-50	4	M5	70	50	4,9	7,1
948-0500-30	949-0500-30	5	M6	55	30	5,9	11,2
948-0500-50	949-0500-50	5	M6	75	50	5,9	11,2
948-0600-30	949-0600-30	6	M8	58	30	7,9	16
948-0600-60	949-0600-60	6	M8	88	60	7,9	16
948-0800-30	949-0800-30	8	M10	68	30	9,9	25
948-0800-60	949-0800-60	8	M10	98	60	9,9	25
948-1000-30	949-1000-30	10	M12	76	30	11,9	41,6
948-1000-60	949-1000-60	10	M12	106	60	11,9	41,6

Material 1.4404 | Not suitable for strands

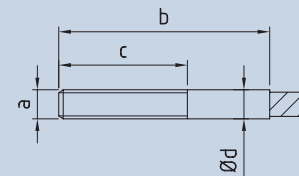

External thread swaged

Part number RH thread	Part number LH thread	ø rope	a	b	c	ø d	kN
850-0100-020	855-0100-020	1	M4	35	20	4	0,5
850-0200-030	855-0200-030	2	M5	55	30	5	2,8
850-0200-060	855-0200-060	2	M5	85	60	5	2,8
850-0300-015	855-0300-015	3	M6	50	15	6	6,3
850-0300-030	855-0300-030	3	M6	70	30	6	6,3
850-0300-060	855-0300-060	3	M6	100	60	6	6,3
850-0400-030	855-0400-030	4	M6	75	30	7	11,2
850-0400-060	855-0400-060	4	M6	105	60	7	11,2
850-0400-061	855-0400-061	4	M8	105	60	8	11,2
850-0500-030	855-0500-030	5	M8	80	30	8	17,5
850-0500-060	855-0500-060	5	M8	110	60	8	17,5
850-0500-080	855-0500-080	5	M8	130	80	8	17,5
850-0600-030	855-0600-030	6	M10	90	30	10	25,2
850-0600-060	855-0600-060	6	M10	120	60	10	25,2
850-0600-080	855-0600-080	6	M10	140	80	10	25,2
850-0800-080	855-0800-080	8	M12	170	80	13	39,5
850-0800-120	855-0800-120	8	M12	210	120	13	39,5
850-1000-115	855-1000-115	10	M16	225	115	18	61,7
850-1200-130	855-1200-130	12	M20	245	130	20	83,2
850-1400-140	855-1400-140	14	M22	260	140	24	104
850-1600-160	855-1600-160	16	M24	290	160	27	140
850-2000-200	855-2000-200	20	M30	355	200	32	176

Material 1.4404

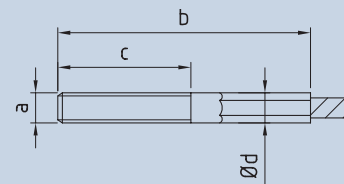



External thread roll swaged

Part number

RH thread	ø rope	a	b	c	ø d
650-0600-045	6	M10	117	45	12,5
650-0800-060	8	M12	156	60	16,1
650-1000-076	10	M14	193	76	17,8
650-1200-090	12	M16	232	90	21,4
650-1400-110	14	M20	259	110	24,9
650-1600-130	16	M24	313	130	28
650-1800-140	18	M27	357	140	34,5
650-2200-170	22	M30	430	170	43
650-2600-170	26	M36	475	170	45,9

Material 1.4404 | General planning approval granted

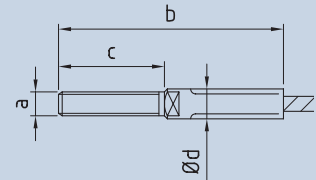

External thread swageless connection

Part number RH thread	Part number LH thread	ø rope	a	ø d	b	c	kN
826-0200-030	827-0200-030	2	M6	13	85	30	2
826-0200-060	827-0200-060	2	M6	13	115	60	2
826-0300-030	827-0300-030	3	M6	13	85	30	4,5
826-0300-060	827-0300-060	3	M6	13	115	60	4,5
826-0400-030	827-0400-030	4	M6	13	85	30	8
826-0400-060	827-0400-060	4	M6	13	115	60	8
826-0500-030	827-0500-030	5	M8	15	87	30	12,6
826-0500-060	827-0500-060	5	M8	15	117	60	12,6
826-0600-030	827-0600-030	6	M8	15	87	30	18,1
826-0600-060	827-0600-060	6	M8	15	117	60	18,1
826-0800-080	827-0800-080	8	M10	20	167	80	32,2
826-1000-100	827-1000-100	10	M14	28	223	100	46,8
826-1200-120	827-1200-120	12	M16	30	257	120	67,6



Material 1.4404 | Not suitable for strand 1 x 19

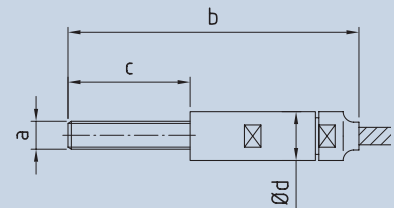

BW-External thread swageless connection

Part number RH thread	Part number LH thread	ø rope	a	l1	l2	kN
751-0300	752-0300	3	M6	85	47	7
751-0400	752-0400	4	M6	92	47	13
751-0500	752-0500	5	M8	111	57	20
751-0600	752-0600	6	M10	128	63	29
751-0800	752-0800	8	M12	162	80	52
751-1000	752-1000	10	M16	188	100	82
751-1200	752-1200	12	M20	222	120	118



Material 1.4404

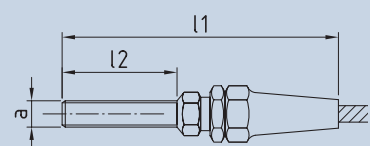



External thread STA-LOK® swageless connection

Part number RH thread	Part number LH thread	ø rope	a	b	c	kN
851-0300	852-0300	3	M6	62	52	5,9
851-0400	852-0400	4	M8	64	54	10,6
851-0500	852-0500	5	M10	78	67	16,4
851-0600	852-0600	6	M12	93	83	23,7
851-0800	852-0800	8	M16	110	95	39,5
851-1000	852-1000	10	M20	129	115	61,7
851-1200	852-1200	12	M22	168	139	83,2
851-1400	852-1400	14	M24	172	139	104
851-1600	852-1600	16	M27	205	171	140
851-1900	852-1900	19	M30	281	228	186
851-2200	852-2200	22	M30	281	228	239
851-2600	852-2600	26	M36	297	232	332

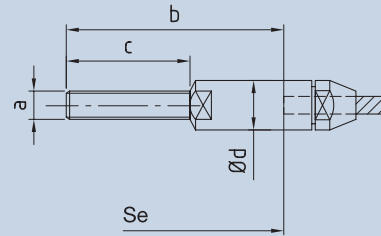

Material 1.4401 | Standard: cone for strand 1 x 19

**ISL-STA-LOK® Cones
Strand 1 x 19**

Part number	ø rope
ISL12.60.03	3
ISL12.60.04	4
ISL12.60.05	5
ISL12.60.06	6
ISL12.60.08	8
ISL12.60.10	10
ISL12.60.12	12
ISL12.60.14	14
ISL12.60.16	16
ISL12.60.19	19
ISL12.60.22	22
ISL12.60.26	26

**ISL-STA-LOK® Cones
Compact strand 1 x 19**

Part number	ø rope
ISL15.40.04	4
ISL15.40.05	5
ISL15.40.06	6
ISL15.40.08	8
ISL15.40.10	10
ISL15.40.12	12
ISL15.40.14	14
ISL15.40.16	16

**ISL-STA-LOK® Cones
Rope 7 x 7 | 7 x 19**

Part number	ø rope
ISL12.70.04	4
ISL12.70.05	5
ISL12.70.06	6
ISL12.70.08	8
ISL12.70.10	10
ISL12.70.12	12
ISL12.70.14	14
ISL12.70.16	16



External thread swivel swaged

Part number	ø rope	a	b	c	ø d	kN
856-0300-030	3	M6	88	30	10	4,5
856-0300-060	3	M6	118	60	10	4,5
856-0400-030	4	M6	88	30	10	8,1
856-0400-060	4	M6	118	60	10	8,1
856-0400-061	4	M8	118	60	10	8,1
856-0500-030	5	M8	108	30	13	12,6
856-0500-080	5	M8	158	80	13	12,6
856-0600-060	6	M10	138	60	13	14,5

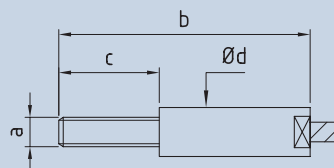

Material 1.4404 | Not suitable for strand 1 x 19

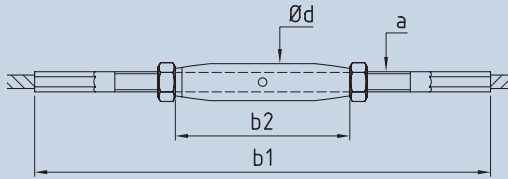

Turnbuckle with external threads swaged

Part number	\varnothing rope	a	b1	b2	\varnothing d	Adjustment	kN
829-0200-01	2	M5	166	80	8	+16 -26	2,8
829-0200-02	2	M5	211	80	8	+30 -40	2,8
829-0300-01	3	M6	207	92	10	+14 -26	6,3
829-0300-02	3	M6	250	92	10	+32 -44	6,3
829-0400-01	4	M6	217	92	10	+14 -26	11,2
829-0400-02	4	M6	260	92	10	+32 -44	11,2
829-0400-03	4	M8	270	112	13,5	+38 -54	11,2
829-0500-01	5	M8	248	112	13,5	+8 -24	17,5
829-0500-02	5	M8	280	112	13,5	+38 -54	17,5
829-0600-01	6	M10	314	120	17,2	+8 -50	25,2
829-0600-02	6	M10	340	120	17,2	+40 -60	25,2
829-0800-01	8	M12	425	150	21,3	+46 -70	39,5
829-1000-01	10	M16	560	190	26,9	+62 -94	61,7
829-1200-01	12	M20	646	220	33,7	+70 -110	83,2
829-1600-01	16	M24	858	328	50	+92 -140	140

Material 1.4404 | Left/right swaged external threads are screwed half way into the turnbuckle.
The minimum screw-in depth is 1.5 x thread \varnothing (M8=12 mm).

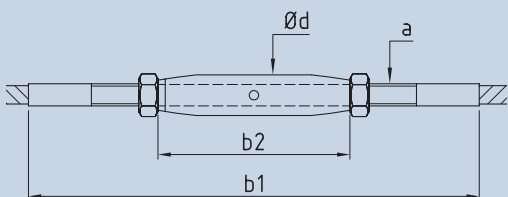

Turnbuckle with external threads F30 hammered

Part number	\varnothing rope	a	b1	b2	\varnothing d	Adjustment	kN
828-0400-02	4	M5	160	80	8	+38 -42	7,1
828-0500-02	5	M6	178	92	10	+32 -40	11,2
828-0600-02	6	M8	214	112	13,5	+36 -47	16
828-0800-02	8	M10	236	120	17,2	+30 -44	25
828-1000-02	10	M12	280	150	21,3	+24 -40	41,6

Material 1.4404 | Left/right hammered external threads are screwed half way into the turnbuckle.
The minimum screw-in depth is 1.5 x thread \varnothing (M8=12 mm).



Both sides external thread swaged

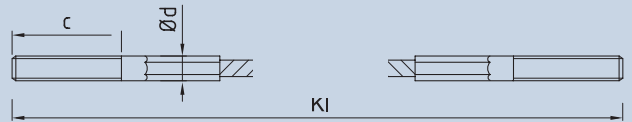

Part number both sides RH thread	Part number one LH thread one RH thread	ørope	Sk	Thread size x length c	ø d
IK 100-0200	IK 101-0200	2	7 x 7	M5 x 30	5
IK 100-0201	IK 101-0201	2	7 x 7	M5 x 60	5
IK 100-0300	IK 101-0300	3	7 x 7	M6 x 30	6
IK 100-0301	IK 101-0301	3	7 x 7	M6 x 60	6
IK 100-0400	IK 101-0400	4	7 x 7	M6 x 30	7
IK 100-0401	IK 101-0401	4	7 x 7	M6 x 60	7
IK 100-0500	IK 101-0500	5	7 x 7	M8 x 30	8
IK 100-0501	IK 101-0501	5	7 x 7	M8 x 60	8
IK 100-0600	IK 101-0600	6	7 x 7	M10 x 30	10
IK 100-0601	IK 101-0601	6	7 x 7	M10 x 60	10
IK 100-0800	IK 101-0800	8	7 x 7	M12 x 80	13
IK 100-1000	IK 101-1000	10	7 x 19	M16 x 115	18
IK 100-1200	IK 101-1200	12	7 x 19	M20 x 130	20
IK 100-1600	IK 101-1600	16	7 x 19	M24 x 160	27
IK 100-2000		20	6 x 36	M30 x 200	32



**Both sides turnbuckle
with external thread swaged**

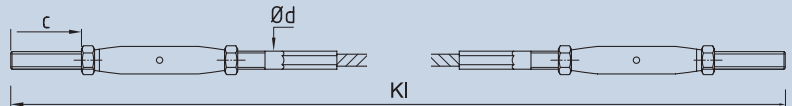

Part number both sides RH thread	ørope	Sk	Thread size x length c	Adjustment	ø d
IK 110-0200	2	7 x 7	M5 x 60	+52 -86	5
IK 110-0300	3	7 x 7	M6 x 60	+56 -100	6
IK 110-0400	4	7 x 7	M6 x 60	+56 -100	7
IK 110-0500	5	7 x 7	M8 x 60	+68 -100	8
IK 110-0600	6	7 x 7	M10 x 60	+60 -100	10
IK 110-0800	8	7 x 7	M12 x 60	+92 -140	13
IK 110-1000	10	7 x 19	M16 x 60	+96 -180	18
IK 110-1200	12	7 x 19	M20 x 60	+120 -210	20
IK 110-1600	16	7 x 19	M24 x 60	+180 -240	27



Both sides external thread F30 hammered

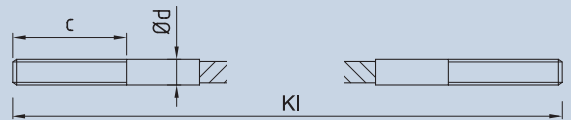

Part number both sides RH thread	Part number one LH thread one RH thread	ørope	Sk	Thread size x length c	ø d
IK 120-0300	IK 121-0300	3	7 x 7	M4 x 20	3,9
IK 120-0301	IK 121-0301	3	7 x 7	M4 x 40	3,9
IK 120-0400	IK 121-0400	4	7 x 7	M5 x 30	4,9
IK 120-0401	IK 121-0401	4	7 x 7	M5 x 50	4,9
IK 120-0500	IK 121-0500	5	7 x 7	M6 x 30	5,9
IK 120-0501	IK 121-0501	5	7 x 7	M6 x 50	5,9
IK 120-0600	IK 121-0600	6	7 x 7	M8 x 30	7,9
IK 120-0601	IK 121-0601	6	7 x 7	M8 x 60	7,9
IK 120-0800	IK 121-0800	8	7 x 7	M10 x 30	9,9
IK 120-0801	IK 121-0801	8	7 x 7	M10 x 60	9,9
IK 120-1000	IK 121-1000	10	7 x 19	M12 x 30	11,9
IK 120-1001	IK 121-1001	10	7 x 19	M12 x 60	11,9



Both sides external thread F50 hammered

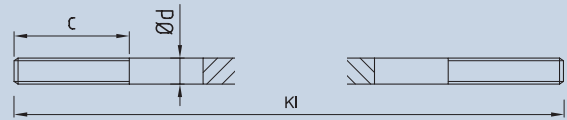

Part number both sides RH thread	Part number one LH thread one RH thread	ørope	Sk	Thread size x length c	ø d
IK 125-0400	IK 126-0400	4	7 x 7	M4 x 30	4,4
IK 125-0401	IK 126-0401	4	7 x 7	M4 x 60	4,4
IK 125-0500	IK 126-0500	5	7 x 7	M5 x 30	5,5
IK 125-0501	IK 126-0501	5	7 x 7	M5 x 60	5,5
IK 125-0600	IK 126-0600	6	7 x 7	M6 x 30	6,6
IK 125-0601	IK 126-0601	6	7 x 7	M6 x 60	6,6
IK 125-0800	IK 126-0800	8	7 x 7	M8 x 30	8,8
IK 125-0801	IK 126-0801	8	7 x 7	M8 x 60	8,8



Both sides turnbuckle with external thread F30 hammered

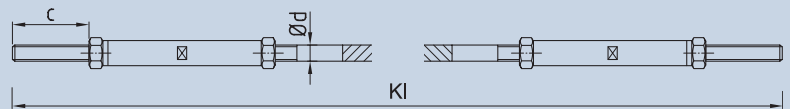

Part number both sides RH thread	ørope	Sk	Thread size x length c	Adjustment	ø d
IK 130-0400	4	7 x 7	M5 x 60	+60 -90	4,9
IK 130-0500	5	7 x 7	M6 x 60	+74 -110	5,9
IK 130-0600	6	7 x 7	M8 x 60	+74 -110	7,9



Both sides external thread swageless connection

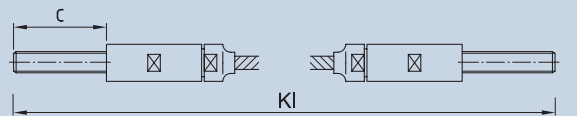

Part number both sides RH thread	Part number one LH thread one RH thread	ørope	Sk	Thread size x length c
IK 140-0200	IK 141-0200	2	7 x 7	M6 x 30
IK 140-0201	IK 141-0201	2	7 x 7	M6 x 60
IK 140-0300	IK 141-0300	3	7 x 7	M6 x 30
IK 140-0301	IK 141-0301	3	7 x 7	M6 x 60
IK 140-0400	IK 141-0400	4	7 x 7	M6 x 30
IK 140-0401	IK 141-0401	4	7 x 7	M6 x 60
IK 140-0500	IK 141-0500	5	7 x 7	M8 x 30
IK 140-0501	IK 141-0501	5	7 x 7	M8 x 60
IK 140-0600	IK 141-0600	6	7 x 7	M8 x 30
IK 140-0601	IK 141-0601	6	7 x 7	M8 x 60
IK 140-0800	IK 141-0800	8	7 x 7	M10 x 80
IK 140-1000	IK 141-1000	10	7 x 19	M14 x 100
IK 140-1200	IK 141-1200	12	7 x 19	M16 x 120



External Threads | Assembly

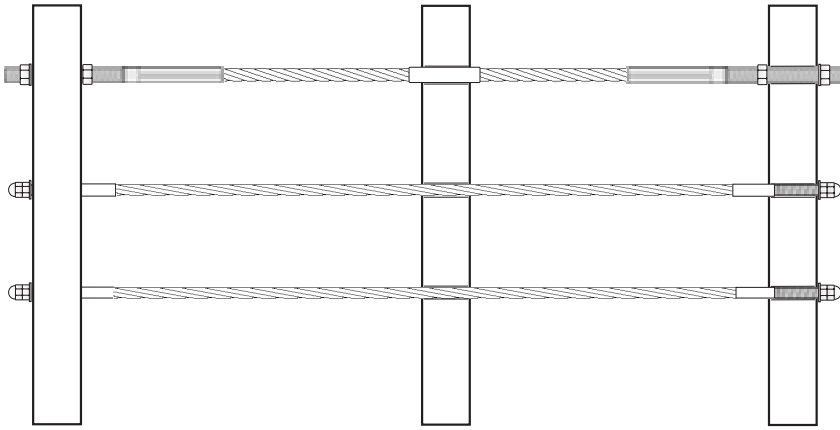

Tension is created within the cable by tightening the nuts. Loose sleeves serve to protect the cables and coated post profiles against abrasion.

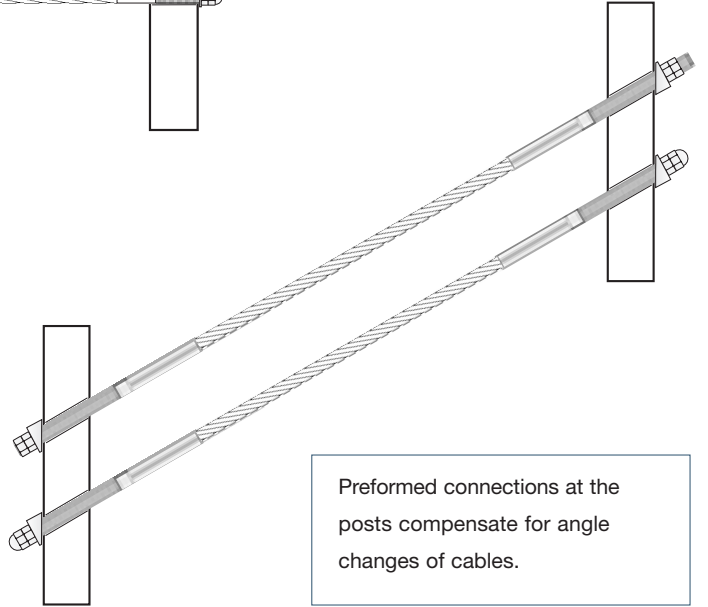

Preformed connections at the posts compensate for angle changes of cables.

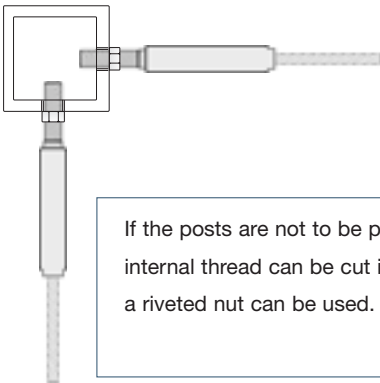

If the posts are not to be penetrated, an internal thread can be cut in the wall or a riveted nut can be used.

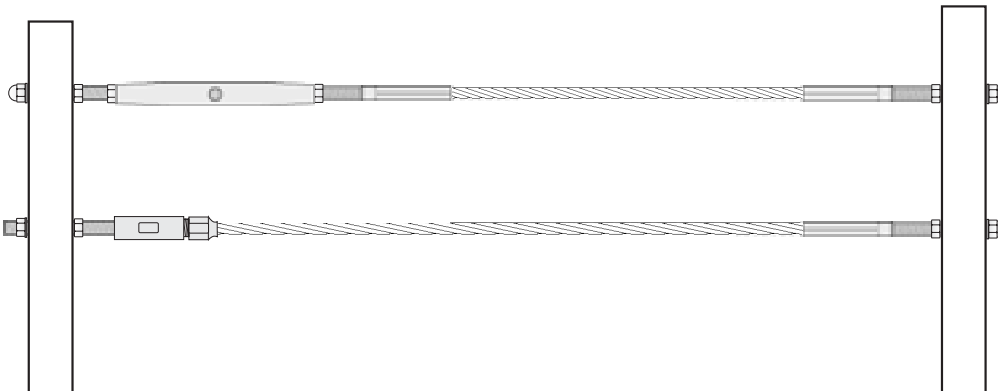
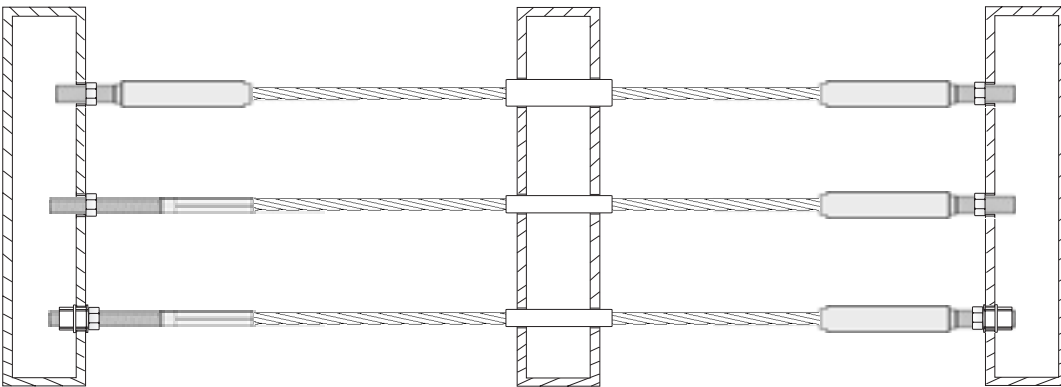

Compensation for large tolerances allows use of ready assembled parts with turnbuckles and end connections for self assembly.









I-SYS: Internal Threads



Long lengths of splendid cable can be seen in bridges and on stairways. They provide safety, divide different areas of use from one another or mark structures in public spaces. Generous forms require the cables to be strung in the right rhythm. Internal threads do sterling service here. Reduced to a minimum as regards form, they secure the cable fixing, maintain cables at the right lengths and keep them parallel to one another.



Internal thread swaged

Part number RH thread	Part number LH thread	ørope	a	b	c	ød	kN
860-0200-015	861-0200-015	2	M4	45	15	6	2,9
860-0300-020	861-0300-020	3	M5	60	20	7	6,7
860-0300-035	861-0300-035	3	M5	90	35	7	6,7
860-0400-020	861-0400-020	4	M6	65	20	8	11,8
860-0400-035	861-0400-035	4	M6	90	35	8	11,8
860-0500-020	861-0500-020	5	M6	70	20	8	12
860-0500-035	861-0500-035	5	M6	100	35	8	12
860-0600-025	861-0600-025	6	M8	90	25	10	16,5
860-0600-050	861-0600-050	6	M8	120	50	10	16,5
860-0800-060	861-0800-060	8	M10	180	60	13	26
860-1000-080	861-1000-080	10	M12	170	80	18	69,5
860-1000-081	861-1000-081	10	M14	185	80	20	69,5
860-1200-100	861-1200-100	12	M16	210	100	24	93,6
860-1600-120	861-1600-120	16	M20	250	120	30	159

Material 1.4404

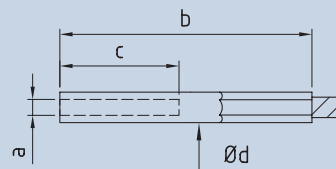

Internal thread swivel swaged

Part number	ørope	a	b	c	ød1	ød2	kN
857-0300-020	3	M5	91	20	10	8	4,6
857-0300-035	3	M5	113	35	10	8	4,6
857-0400-020	4	M6	91	20	10	8	8,1
857-0400-035	4	M6	113	35	10	8	8,1
857-0500-020	5	M6	111	20	13	10	12
857-0500-035	5	M6	133	35	13	10	12
857-0600-025	6	M8	116	25	13	10	12,5
857-0600-050	6	M8	148	50	13	10	12,5

Material 1.4404 | Not suitable for strand 1 x 19

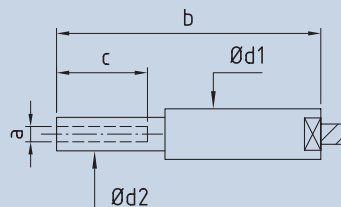

Internal thread swageless connection

Part number RH thread	Part number LH thread	ørope	a	b	c	ød	kN
831-0200	832-0200	2	M6	55	18	13	2
831-0300	832-0300	3	M6	55	18	13	4,5
831-0400	832-0400	4	M6	55	18	13	8
831-0500	832-0500	5	M8	57	20	15	12,6
831-0600	832-0600	6	M8	57	20	15	18,1
831-0800	832-0800	8	M10	87	40	20	32,2
831-1000	832-1000	10	M14	123	60	28	46,8
831-1200	832-1200	12	M16	137	60	30	67,6

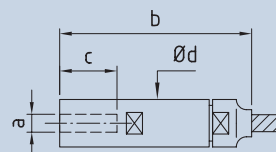

Material 1.4404 | Not suitable for strand 1 x 19

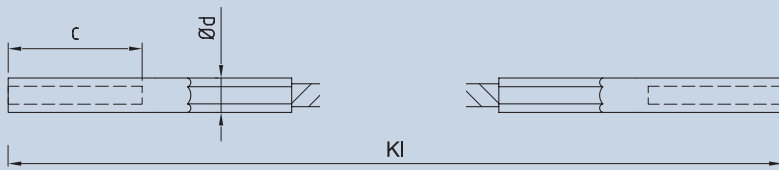

Both sides internal thread swaged

Part number both sides RH thread	Part number one LH thread one RH thread	ørope	Sk	Thread size x length c	ø d
IK 200-0200	IK 201-0200	2	7 x 7	M4 x 15	6
IK 200-0300	IK 201-0300	3	7 x 7	M5 x 20	7
IK 200-0301	IK 201-0301	3	7 x 7	M5 x 35	7
IK 200-0400	IK 201-0400	4	7 x 7	M6 x 20	8
IK 200-0401	IK 201-0401	4	7 x 7	M6 x 35	8
IK 200-0500	IK 201-0500	5	7 x 7	M6 x 20	8
IK 200-0501	IK 201-0501	5	7 x 7	M6 x 35	8
IK 200-0600	IK 201-0600	6	7 x 7	M8 x 25	10
IK 200-0601	IK 201-0601	6	7 x 7	M8 x 50	10
IK 200-0800	IK 201-0800	8	7 x 7	M10 x 60	13
IK 200-1000	IK 201-1000	10	7 x 19	M12 x 80	18
IK 200-1200	IK 201-1200	12	7 x 19	M16 x 100	24
IK 200-1600	IK 201-1600	16	7 x 19	M20 x 120	30

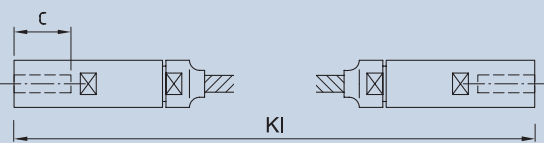

Both sides internal thread swageless connection

Part number both sides RH thread	Part number one LH thread one RH thread	ørope	Sk	Thread size x length c
IK 210-0200	IK 211-0200	2	7 x 7	M6 x 18
IK 210-0300	IK 211-0300	3	7 x 7	M6 x 18
IK 210-0400	IK 211-0400	4	7 x 7	M6 x 18
IK 210-0500	IK 211-0500	5	7 x 7	M8 x 20
IK 210-0600	IK 211-0600	6	7 x 7	M8 x 20
IK 210-0800	IK 211-0800	8	7 x 7	M10 x 40
IK 210-1000	IK 211-1000	10	7 x 19	M14 x 60
IK 210-1200	IK 211-1200	12	7 x 19	M16 x 60



Internal Threads | Assembly

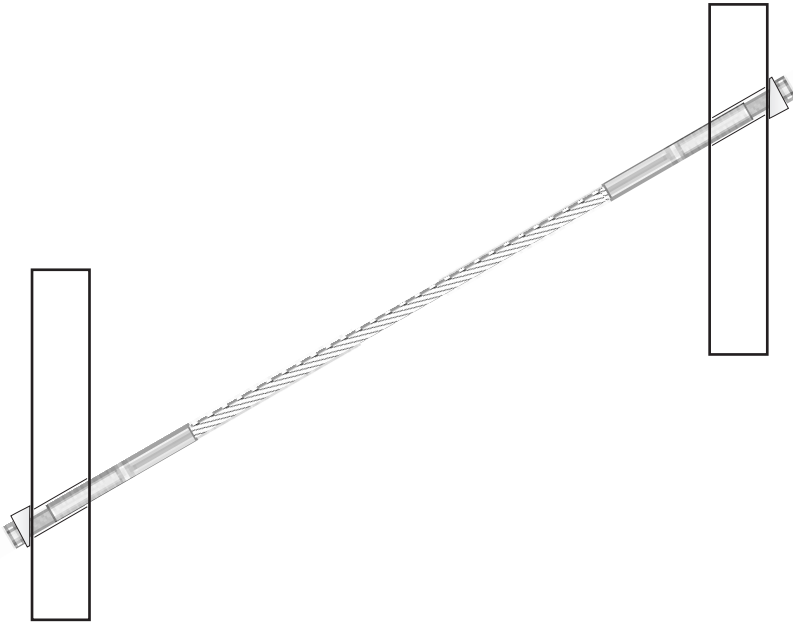

Preformed connections at the posts compensate for the angle changes.

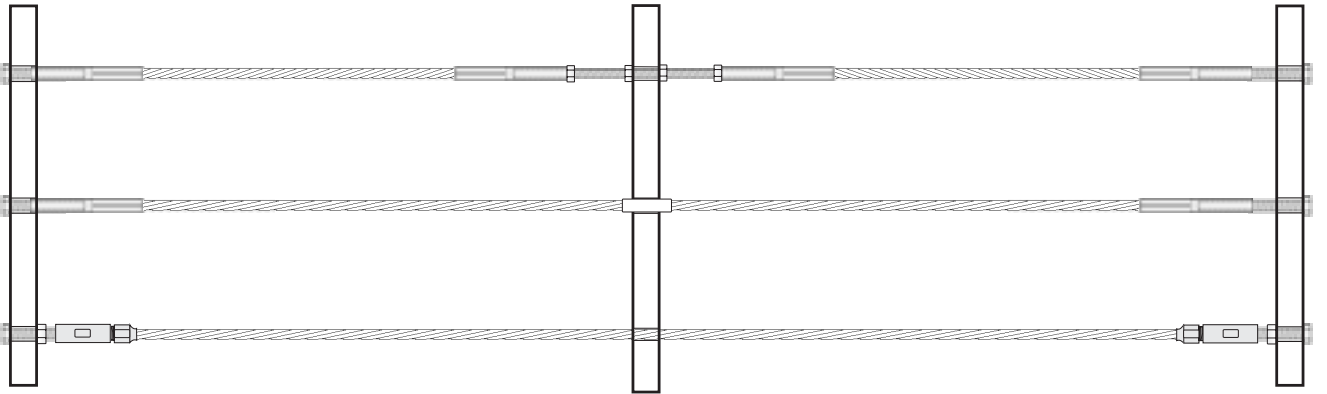

A cable stop with internal thread at the post fixes the cable up to 10 metres each in length (top). Loose sleeves protect the cable and finish of the post (centre). Tensioning at the end posts is sufficient for short lengths (below).

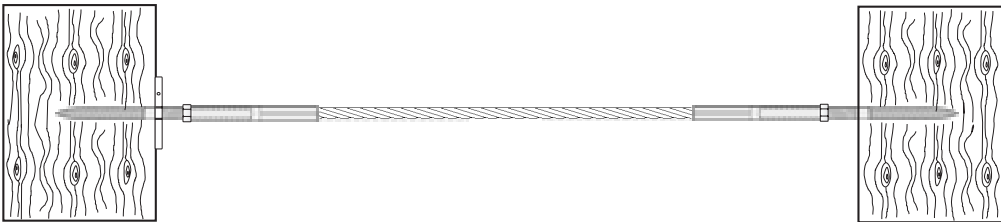

I-SYS accessories are available for fixing cable assemblies with internal thread to the different bases.

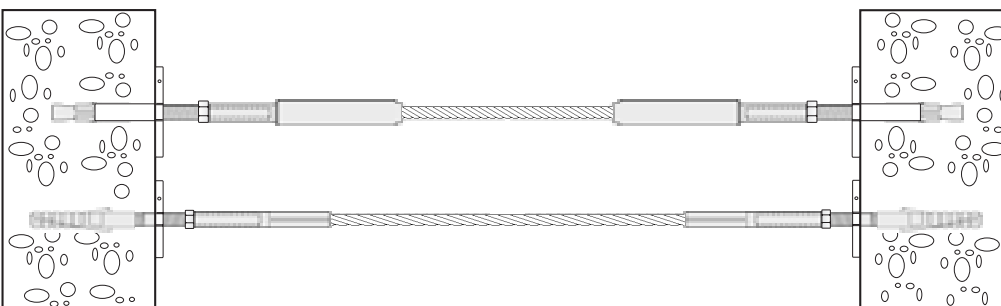











I-SYS: Forks

Slim and elegant, but strong and long lived: these are the requirements placed on connections between cable and building. Intelligent design is absolutely essential. The I-SYS range impresses with its unique aesthetic qualities. Refined technical processing of the stainless steel in conjunction with organic forms are typical of CS-Forks and CS-Eyes. The international jury of the leading architectural journal AIT awarded the range the highly-regarded »Innovation Prize for Architecture and Construction«, recognising the new elegance of these industrial elements.



CS-Fork with external thread

Part number RH thread	Part number LH thread	a	b	c	ød	e	f	g	h
945-0600	946-0600	M6	77	35	6	7,5	14	6,5	20
945-0800	946-0800	M8	77	35	6	7,5	14	6,5	20
945-0801	946-0801	M8	106	50	8	10	19	8,5	24
945-1000	946-1000	M10	106	50	8	10	19	8,5	24

Material 1.4401 | CS-Fork is compatible with CS-Eye

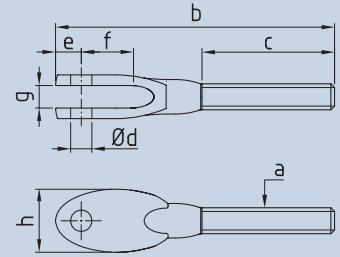

BW-Fork with external thread

Part number RH thread	Part number LH thread	a	b	c	ød	e	f	g	øh
845-0600-01	846-0600-01	M6	72	30	6	8,75	18	8	15
845-0600	846-0600	M6	89	47	6	8,75	18	8	15
845-0800-01	846-0800-01	M8	82	35	8	10	20,5	10	16,8
845-0800	846-0800	M8	104	57	8	10	20,5	10	16,8
845-1000	846-1000	M10	121,5	63	9,5	11	25,5	12	22,5

Material 1.4401

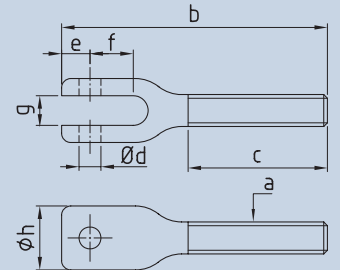

Fork with external thread

Part number RH thread	Part number LH thread	a	b	c	ød	e	f	g	h
871-0500-01	872-0500-01	M5	55	30	5	6	12	7,5	12,5
871-0500	872-0500	M5	66	41	5	6	12	7,5	12,5
871-0600-01	872-0600-01	M6	56	30	5	6	12	7,5	12,5
871-0600	872-0600	M6	73	47	5	6	12	7,5	12,5
871-0800-01	872-0800-01	M8	64	35	6	7	13	10	14,5
871-0800	872-0800	M8	86	57	6	7	13	10	14,5
871-1000	872-1000	M10	99	63	8	9	15	11	18
871-1200	872-1200	M12	133	80	12	14	25	14	26
871-1400	872-1400	M14	143	90	12	14	25	14	26
871-1600	872-1600	M16	167	100	14	18	31	22	34
871-2000	872-2000	M20	214	119	19	22	42	24	42
871-2400	872-2400	M24	286	170	25	28	50	30	50

Material 1.4401

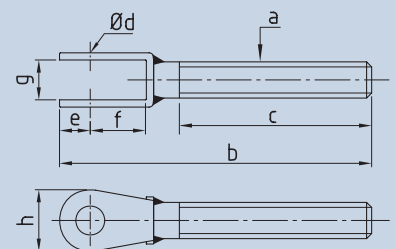



CS-Fork with internal thread

Part number RH thread	Part number LH thread	a	b	c	ød1	ød2	e	f	g	h
917-0500	918-0500	M5	78	40	6	10	7,5	14	6,5	20
917-0600	918-0600	M6	78	40	6	10	7,5	14	6,5	20
917-0800	918-0800	M8	78	40	6	10	7,5	14	6,5	20
917-0801	918-0801	M8	106	55	8	13	10	19	8,5	24
917-1000	918-1000	M10	106	55	8	13	10	19	8,5	24

Material 1.4401 | CS-Fork is compatible with CS-Eye

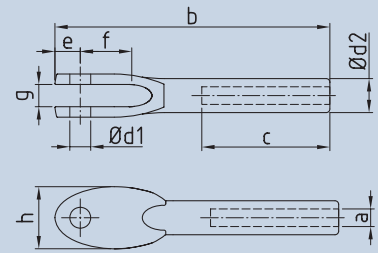

Fork with internal thread

Part number RH thread	Part number LH thread	a	b	c	ød1	ød2	e	f	g
817-0400	818-0400	M4	29	10	4	10	7	7	3,5
817-0500	818-0500	M5	36	13	5	12	8	9	5
817-0600	818-0600	M6	43	18	6	14	9	10	6
817-0800	818-0800	M8	54	24	8	18	12	12,5	7
817-1000	818-1000	M10	69	30	10	22	15	15	8
817-1200	818-1200	M12	81	36	12	26	17	18	10
817-1600	818-1600	M16	100	40	16	34	22	22	12
817-2000	818-2000	M20	122	40	20	42	27	27	15
817-2400	818-2400	M24	150	40	22	52	34	34	18

Material 1.4401 | Fork with internal thread is compatible with eye with internal thread

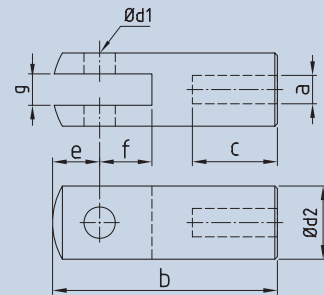



CS-Fork swaged

Part number	ørope	b	ø d1	ø d2	e	f	g	h	kN
947-0400	4	78	6	7,8	7,5	14	6,5	20	11,8
947-0500	5	78	6	7,8	7,5	14	6,5	20	12
947-0600	6	106	8	9,8	10	19	8,5	24	16,5

Material 1.4401

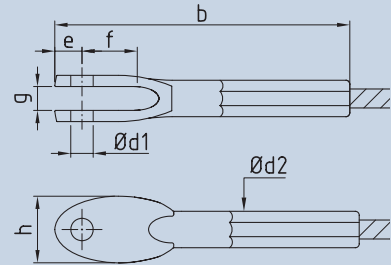

BW-Fork swaged

Part number	ørope	b	ø d1	ø d2	e	f	g	h	kN
847-0300	3	89	6	6,35	8,75	18	8	15	6,6
847-0400	4	89	6	7,5	8,75	18	8	15	11,8
847-0500	5	104	8	9	10	20,5	10	16,8	18,5
847-0600	6	121	9,5	12,58	11	25,5	12	22,5	26,7

Material 1.4401

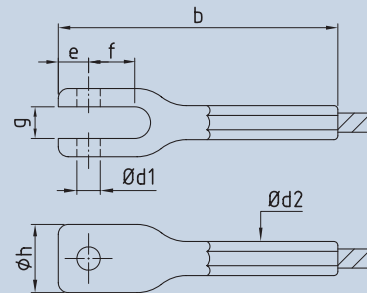

Fork swaged

Part number	ørope	b	ø d1	ø d2	e	f	g	h	kN
881-0200	2	65	5	5,5	6	12	7,5	12,5	2,9
881-0300	3	70	5	6,3	6	12	7,5	12,5	6,6
881-0400	4	80	6	7,5	7	13	10	14,5	11,8
881-0401	4	77	5	7,5	6	12	7,5	12,5	11,8
881-0500	5	93	8	9	9	15	11	17,5	18,5
881-0501	5	87,5	6	9	7,5	13	9,5	14,5	18,5
881-0600	6	112	9,5	12,5	11	20	12	20,5	26,7
881-0601	6	106,5	8	12,5	9,5	15	11	17,5	26,7
881-0800	8	143	12	16	14	25	14	26	44,5
881-1000	10	167	14	17,8	18	31	22	34	69,4
881-1200	12	205	16	20	18	31	22	34	93,6
881-1201	12	227	19	20	22	38	24	42	93,6
881-1600	16	309	25,4	28	28	48	30	42	158

Material 1.4401

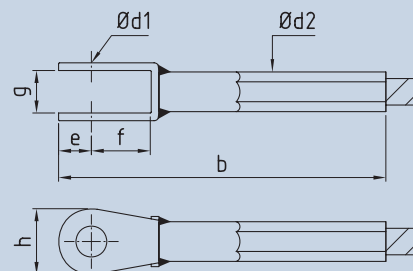

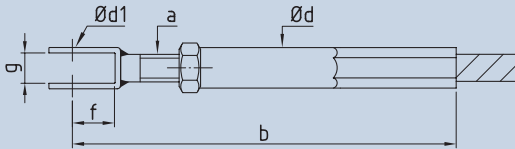

Fork with internal thread swaged

Part number RH thread	Part number LH thread	ørope	a	b	ø d	ø d1	f	g	Adjustment	kN
812-0300-01	811-0300-01	3	M5	100	7	5	12	7,5	+5 -10	6,7
812-0300-02	811-0300-02	3	M5	136	7	5	12	7,5	+12 -17	6,7
812-0400-01	811-0400-01	4	M6	106	8	5	12	7,5	+4 -10	11,8
812-0400-02	811-0400-02	4	M6	135	8	5	12	7,5	+11 -17	11,8
812-0500-01	811-0500-01	5	M6	110	8	5	12	7,5	+4 -10	12
812-0500-02	811-0500-02	5	M6	145	8	5	12	7,5	+11 -17	12
812-0600-01	811-0600-01	6	M8	135	10	6	13	10	+4 -12	16,5
812-0600-02	811-0600-02	6	M8	173	10	6	13	10	+17 -25	16,5
812-0800-01	811-0800-01	8	M10	248	13	8	15	11	+17 -27	26
812-1000-01	811-1000-01	10	M14	295	20	12	25	14	+26 -40	69,5
812-1200-01	811-1200-01	12	M16	345	25	14	31	22	+26 -42	93,6
812-1600-01	811-1600-01	16	M20	410	32	19	42	24	+30 -50	159

Material 1.4401

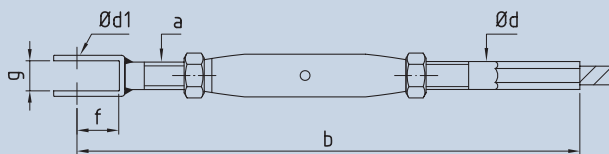

Turnbuckle with fork swaged

Part number	ørope	a	b	ø d	ø d1	f	g	Adjustment	kN
870-0200	2	M5	190	5	5	12	7,5	+26 -43	2,9
870-0300	3	M6	220	6	5	12	7,5	+28 -50	6,6
870-0400	4	M6	225	7	5	12	7,5	+28 -50	11,5
870-0401	4	M8	248	8	6	13	10	+34 -50	11,8
870-0500	5	M8	254	8	6	13	10	+34 -50	18,5
870-0600	6	M10	283	10	8	15	11	+30 -50	26,7
870-0800	8	M12	368	13	12	25	14	+46 -70	44,5
870-1000	10	M16	490	18	14	31	22	+48 -90	69,4
870-1200	12	M20	580	20	19	42	24	+60 -105	93,6
870-1600	16	M24	680	27	25	50	30	+90 -120	158

Material 1.4401



BW-Fork swageless connection

Part number	ørope	g	ød	l1	l2	l3	kN
754-0300	3	6	6	55	63	11	7
754-0400	4	8	8	62	73	12	13
754-0500	5	10	10	72	83	15	20
754-0600	6	12	12	82	95	18	29
754-0800	8	14	14	103	118	21	52
754-1000	10	16	16	115	133	24	82
754-1200	12	18	19	137	157	27	118

 Material 1.4401

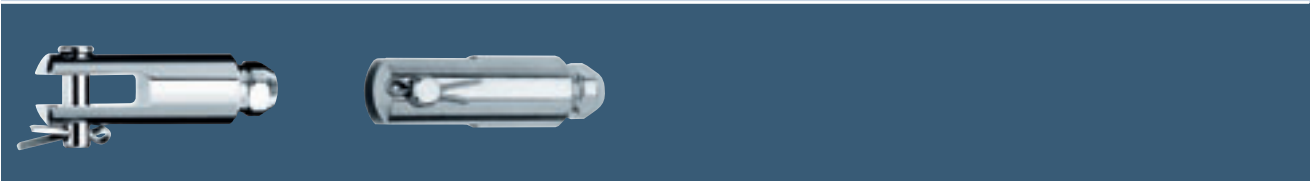
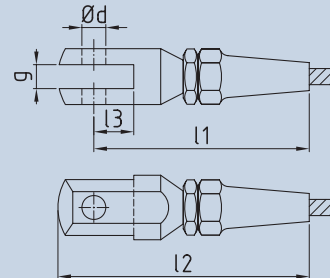

Fork STA-LOK® swageless connection

Part number	ørope	ød	h	e	f	g	kN
854-0300	3	5	15,5	7,8	10	5,4	5,9
854-0400	4	6,3	21,1	8,9	14,7	6,4	10,6
854-0500	5	8	24,4	11,4	18	8	16,4
854-0600	6	10,9	30,2	15,8	22,2	9,7	23,7
854-0800	8	12,5	37	19,2	27,4	13,7	39,5
854-1000	10	15,6	39,7	22,6	29,4	13,7	61,7
854-1200	12	18,5	46	25,5	33,3	19,4	83,2
854-1400	14	21,5	54	31,5	38,1	20,4	104
854-1600	16	21,5	57,5	33,6	40	20,4	140
854-1900	19	27	73,8	40,8	50	27,8	186
854-2200	22	33	152,4	57,1	60,3	34,9	239
854-2600	26	33	152,4	57,1	60,3	34,9	323

Material 1.4401 | Standard: cone for strand 1 x 19

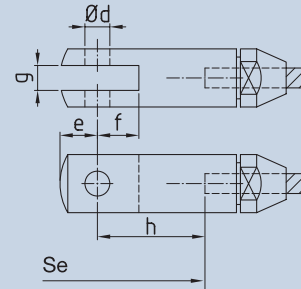

**ISL-STA-LOK® Cones
Strand 1 x 19**

Part number	ørope
ISL12.60.03	3
ISL12.60.04	4
ISL12.60.05	5
ISL12.60.06	6
ISL12.60.08	8
ISL12.60.10	10
ISL12.60.12	12
ISL12.60.14	14
ISL12.60.16	16
ISL12.60.19	19
ISL12.60.22	22
ISL12.60.26	26

**ISL-STA-LOK® Cones
Compact strand 1 x 19**

Part number	ørope
ISL15.40.04	4
ISL15.40.05	5
ISL15.40.06	6
ISL15.40.08	8
ISL15.40.10	10
ISL15.40.12	12
ISL15.40.14	14
ISL15.40.16	16

**ISL-STA-LOK® Cones
Rope 7 x 7 | 7 x 19**

Part number	ørope
ISL12.70.04	4
ISL12.70.05	5
ISL12.70.06	6
ISL12.70.08	8
ISL12.70.10	10
ISL12.70.12	12
ISL12.70.14	14
ISL12.70.16	16



Fork roll swaged

Part number	ø rope	b	ø d	ø d1	e	f	g	h
681-0600	6	116	10	12,5	14	18	10	22
681-0800	8	151	12	16,1	16	24	12	28
681-1000	10	185	16	17,8	20	29	14	34
681-1200	12	220	20	21,4	25	35	17	41
681-1400	14	238	23	24,9	28	41	20	48
681-1600	16	286	26	28	33	48	22	54,5
681-1800	18	335	29	34,5	38	53	28	69,5
681-2200	22	379	33	43	40	61	30	72
681-2600	26	445	36	45,9	45	71	33	83

Material 1.4404 | General planning approval granted

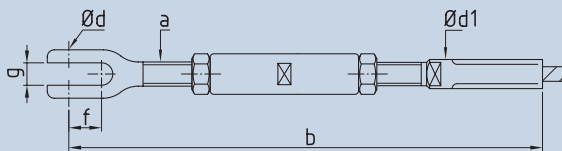
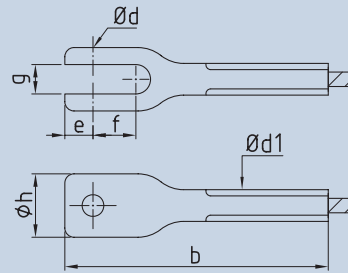

Turnbuckle with fork fitting

Part number	ø rope	a	b	e	f	g	ø d	ø d1	Adjustment
670-0600	6	M10	231	14	18	10	10	12,5	+13 -43
670-0800	8	M12	307	16	24	12	12	16,1	+22 -58
670-1000	10	M14	346	20	29	14	16	17,8	+31 -73
670-1200	12	M16	458	25	35	17	20	21,4	+39 -87
670-1400	14	M20	535	28	41	20	23	24,9	+46 -106
670-1600	16	M24	644	33	48	22	26	28	+60 -126
670-1800	18	M27	712	38	53	28	29	34,5	+54 -135
670-2200	22	M30	850	40	61	30	33	43	+74 -164
670-2600	26	M36	913	45	71	33	36	45,9	+56 -164

Material 1.4404 | General planning approval granted

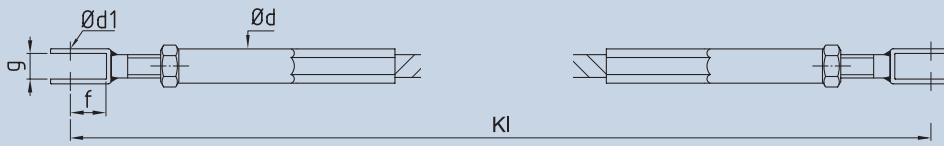

Both sides fork with internal thread swaged

Part number	ørope	Sk	Thread	Adjustment	ø d	f	g	ø d1
IK 300-0300	3	7 x 7	M5	+10 -20	7	12	7,5	5
IK 300-0301	3	7 x 7	M5	+24 -34	7	12	7,5	5
IK 300-0400	4	7 x 7	M6	+8 -20	8	12	7,5	5
IK 300-0401	4	7 x 7	M6	+22 -34	8	12	7,5	5
IK 300-0500	5	7 x 7	M6	+8 -20	8	12	7,5	5
IK 300-0501	5	7 x 7	M6	+22 -34	8	12	7,5	5
IK 300-0600	6	7 x 7	M8	+8 -24	10	13	10	6
IK 300-0601	6	7 x 7	M8	+34 -50	10	13	10	6
IK 300-0800	8	7 x 7	M10	+34 -54	13	15	11	8
IK 300-1000	10	7 x 19	M14	+52 -80	20	25	14	12
IK 300-1200	12	7 x 19	M16	+52 -84	25	31	22	14
IK 300-1600	16	7 x 19	M20	+60 -100	32	42	24	19

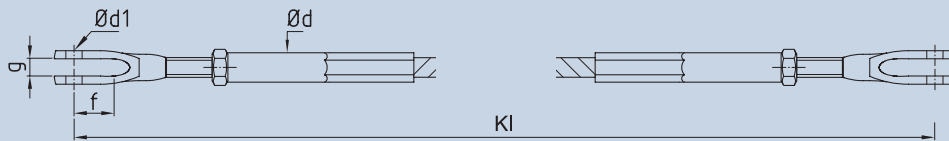

Both sides CS-Fork with internal thread swaged

Part number	ørope	Sk	Thread	Adjustment	ø d	f	g	ø d1
IK 305-0400	4	7 x 7	M6	+14 -22	8	14	6,5	6
IK 305-0500	5	7 x 7	M6	+14 -22	8	14	6,5	6
IK 305-0600	6	7 x 7	M8	+22 -42	10	19	8,5	8
IK 305-0800	8	7 x 7	M10	+22 -42	13	19	8,5	8

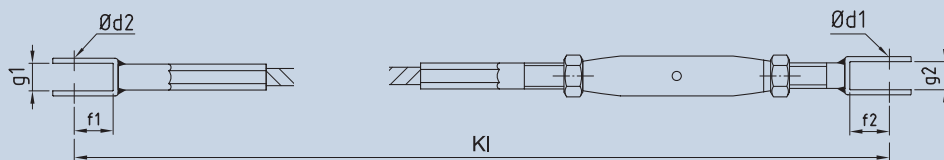
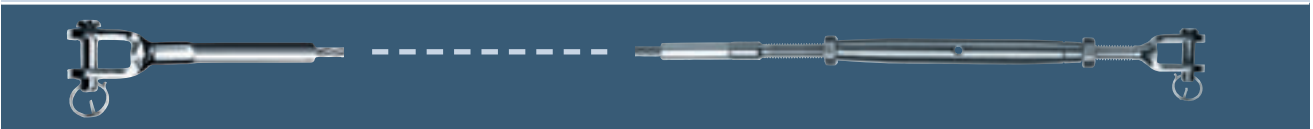

One side turnbuckle with fork, other side with fork swaged

Part number	ørope	Sk	Thread	Adjustment	f1	g1	ø d1	f2	g2	ø d2
IK 310-0200	2	7 x 7	M5	+26 -43	12	7,5	5	12	7,5	5
IK 310-0300	3	7 x 7	M6	+28 -50	12	7,5	5	12	7,5	5
IK 310-0400	4	7 x 7	M6	+28 -50	13	10	5	12	7,5	5
IK 310-0401	4	7 x 7	M8	+34 -50	13	10	6	13	10	6
IK 310-0500	5	7 x 7	M8	+34 -50	15	11	6	13	10	6
IK 310-0600	6	7 x 7	M10	+30 -50	20	12	8	15	11	9,5
IK 310-0800	8	7 x 7	M12	+46 -70	25	14	12	25	14	12
IK 310-1000	10	7 x 19	M16	+48 -90	31	22	14	31	22	14
IK 310-1200	12	7 x 19	M20	+60 -105	31	22	19	42	24	16
IK 310-1600	16	7 x 19	M24	+90 -120	42	30	25	42	30	25,4

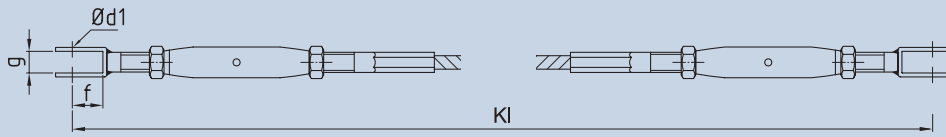

Both sides turnbuckle with fork swaged

Part number	ørope	Sk	Thread	Adjustment	ø d1	f	g
IK 320-0200	2	7 x 7	M5	+52 -86	5	12	7,5
IK 320-0300	3	7 x 7	M6	+56 -100	5	12	7,5
IK 320-0400	4	7 x 7	M6	+56 -100	5	12	7,5
IK 320-0401	4	7 x 7	M8	+68 -100	6	13	10
IK 320-0500	5	7 x 7	M8	+68 -100	6	13	10
IK 320-0600	6	7 x 7	M10	+60 -100	8	15	11
IK 320-0800	8	7 x 7	M12	+92 -140	12	25	14
IK 320-1000	10	7 x 19	M16	+96 -180	14	32	22
IK 320-1200	12	7 x 19	M20	+120 -210	19	42	24
IK 320-1600	16	7 x 19	M24	+180 -240	25	42	25,4



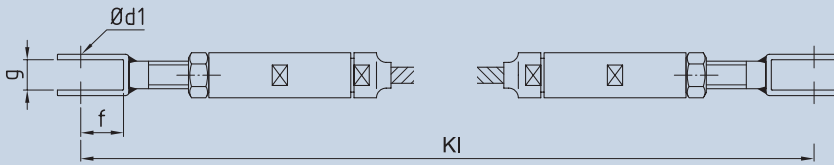

Both sides fork with internal thread swageless connection

Part number	ø Seil	Sk	Thread	Adjustment	ø d1	f	g
IK 330-0200	2	7 x 7	M6	+8 -20	5	12	7,5
IK 330-0300	3	7 x 7	M6	+8 -20	5	12	7,5
IK 330-0400	4	7 x 7	M6	+8 -20	5	12	7,5
IK 330-0500	5	7 x 7	M8	+8 -20	6	13	10
IK 330-0600	6	7 x 7	M8	+8 -20	6	13	10
IK 330-0800	8	7 x 7	M10	+10 -40	8	15	11
IK 330-1000	10	7 x 19	M14	+30 -60	12	25	14
IK 330-1200	12	7 x 19	M16	+30 -60	14	31	22

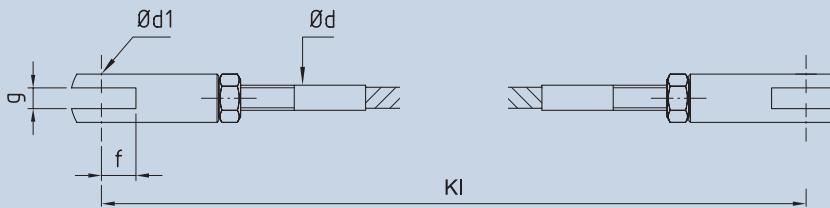

Both sides with external thread F30 complete with fork with internal thread

Part number	ø rope	Sk	Thread	Adjustment	ø d	f	g	ø d1
IK 340-0300	3	7 x 7	M4	+4 -12	3,9	7	3,5	4
IK 340-0400	4	7 x 7	M5	+6 -14	4,9	9	5	5
IK 340-0500	5	7 x 7	M6	+6 -18	5,9	10	6	6
IK 340-0600	6	7 x 7	M8	+8 -30	7,9	12,5	7	8
IK 340-0800	8	7 x 7	M10	+10 -44	9,9	15	8	10
IK 340-1000	10	7 x 19	M12	+16 -40	11,9	18	10	12

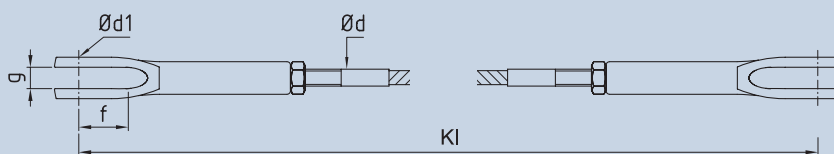

Both sides with external thread F30 complete with CS-Fork with internal thread

Part number	ø rope	Sk	Thread	Adjustment	ø d	f	g	ø d1
IK 345-0400	4	7 x 7	M5	+29 -34	4,9	14	6,5	6
IK 345-0500	5	7 x 7	M6	+29 -34	5,9	14	6,5	6
IK 345-0600	6	7 x 7	M8	+30 -49	7,9	19	8,5	8
IK 345-0800	8	7 x 7	M10	+30 -49	9,9	19	8,5	8

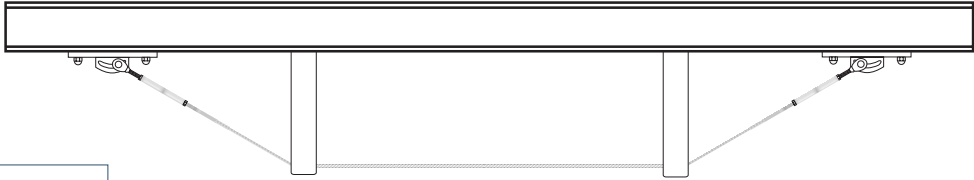

The cable assemblies with turnbuckle and forks on both sides are suitable for truss arrangements.

Cable assemblies with turnbuckle on one side are useful for bracing.

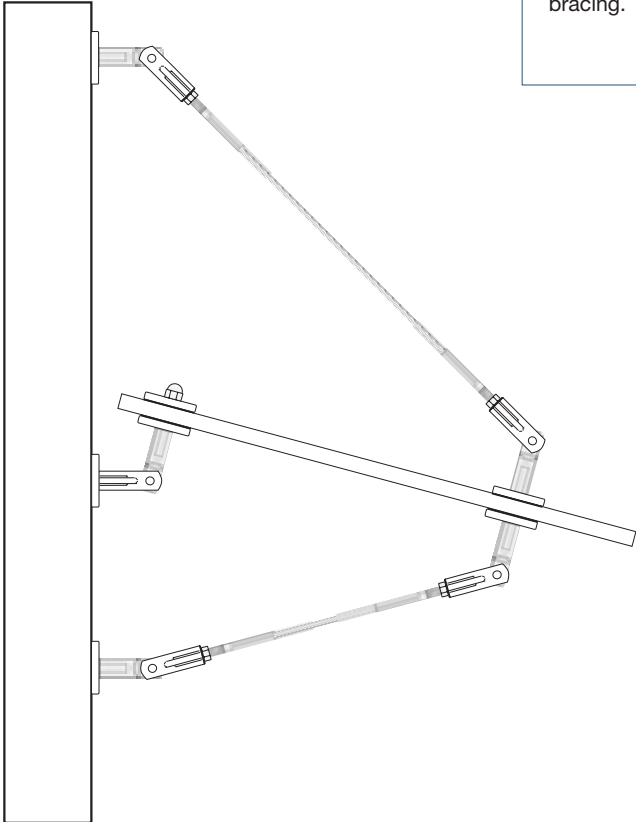
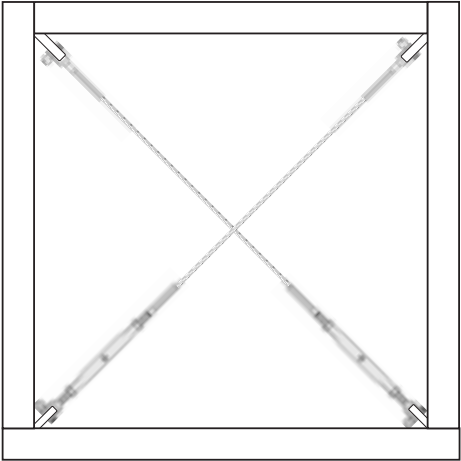

Combination of forks and eyes allow angled connections to be freely selected.

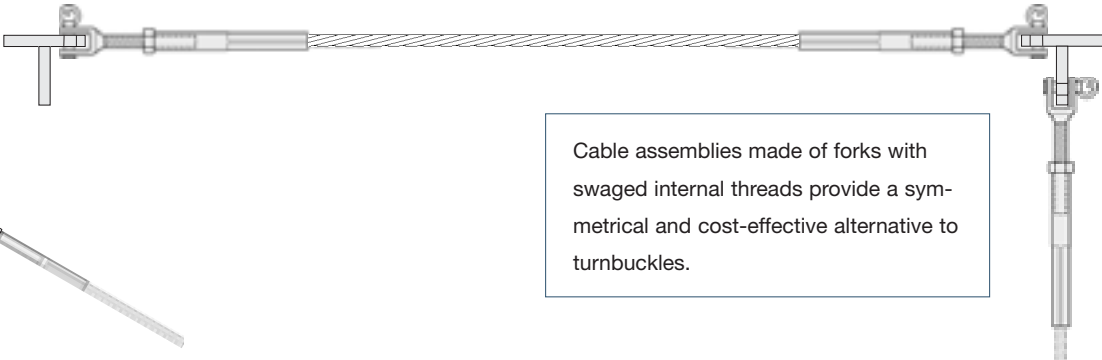

Cable assemblies made of forks with swaged internal threads provide a symmetrical and cost-effective alternative to turnbuckles.

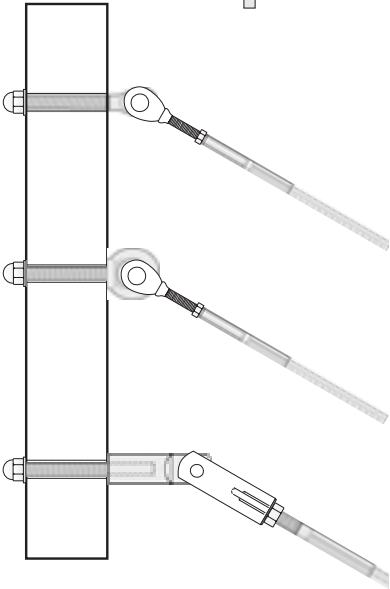

Examples for combinations with eyes and forks.





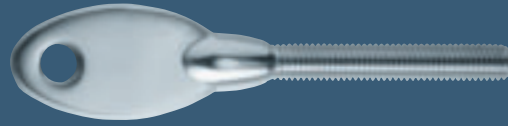

I-SYS: Eyes

As a counterpart to the forks, eyes complete the pair as regards detailed design and long lifetime. Offering a strong connection, yet also flexibly jointed, this type of coupling even goes around corners. Used alone, eyes can also be used to guide cables or for anchorage within the shell of the building.



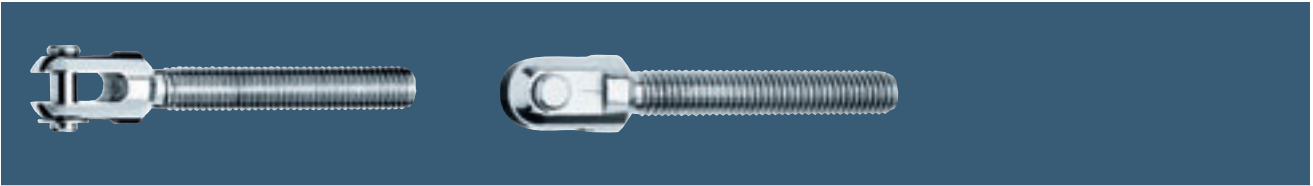

Eye counterpiece

Part number	a	b	c	ød1	ød2	f1	f2	g
887-0800	M8	72	48	13	5	6,5	16	5

Material 1.4401

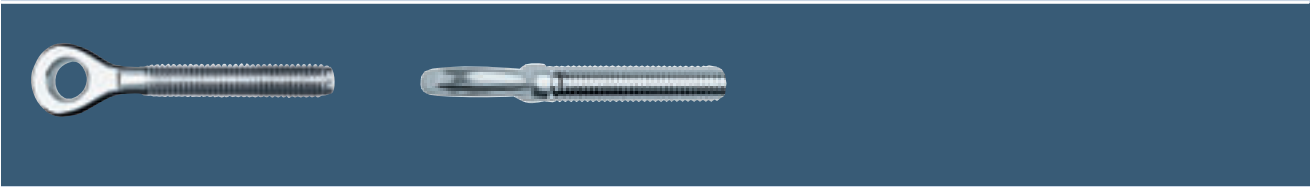
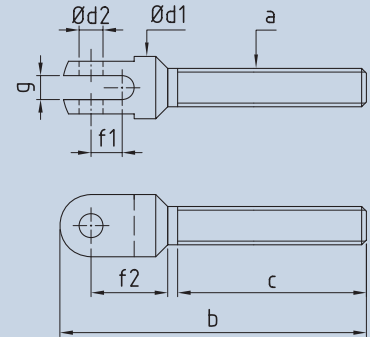

Eye with external thread

Part number RH thread	Part number LH thread	a	b	c	ød	e	f	h	k
885-0500	886-0500	M5	14	41	5,5	6	63	12	3
885-0500-01	886-0500-01	M5	15	25	5,5	6	46	12	3
885-0600	886-0600	M6	16	47	6,5	7	61	14	4
885-0600-01	886-0600-01	M6	16	30	6,5	7	44	14	4
885-0800	886-0800	M8	21	57	8,5	8,5	78	17	5
885-0800-01	886-0800-01	M8	21	35	8,5	9,5	55,5	17	5
885-1000	886-1000	M10	29	63	10,5	12	90	22	6
885-1200	886-1200	M12	31	80	13	14	110	25	8
885-1400	886-1400	M14	34	90	13	14	124	28	9
885-1600	886-1600	M16	37	100	14,5	15,5	133	31	10
885-2000	886-2000	M20	49	120	19,5	21	164	40	15

Material 1.4401

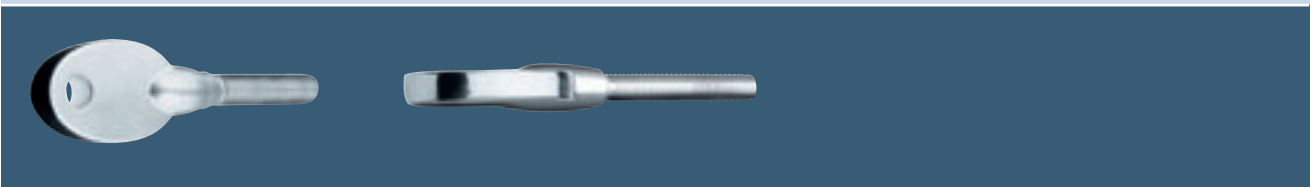
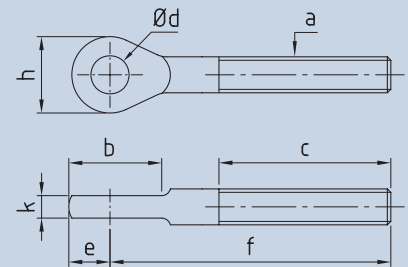

CS-Eye with external thread

Part number RH thread	Part number LH thread	a	b	c	ød	e	f	h	k
985-0600	986-0600	M6	78	32	6	8	19	20	6
985-0800	986-0800	M8	78	32	6	8	19	20	6
985-0801	986-0801	M8	106	47	8	10	23	24,5	8
985-1000	986-1000	M10	106	47	8	10	23	24,5	8

Material 1.4401 | CS-Eye is compatible with CS-Fork

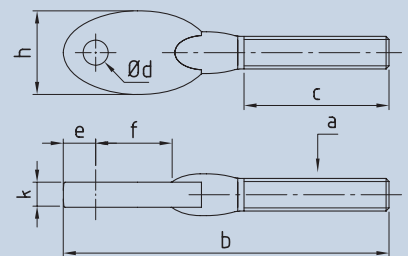



CS-Eye with internal thread

Part number RH thread	Part number LH thread	a	b	c	ø d	e	f	h	k
906-0500	907-0500	M5	78	40	6	8	19	20	6
906-0600	907-0600	M6	78	40	6	8	19	20	6
906-0800	907-0800	M8	78	40	6	8	19	20	6
906-0801	907-0801	M8	106	55	8	10	23	24,5	8
906-1000	907-1000	M10	106	55	8	10	23	24,5	8

Material 1.4401 | CS-Eye is compatible with CS-Fork

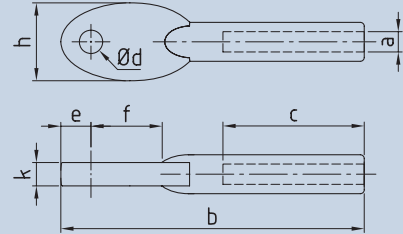

Eye with internal thread

Part number RH thread	Part number LH thread	a	b1	b2	c	ø d1	ø d2	e	f	k
806-0400	807-0400	M4	32	13,5	14	4	10	6	26	3,4
806-0500	807-0500	M5	39	16	16	5	12	7	32	4,9
806-0600	807-0600	M6	46	18,5	17	6	14	8	38	5,9
806-0800	807-0800	M8	62	24,5	25	8	18	10,5	51,5	6,9
806-1000	807-1000	M10	74	30	30	10	22	13	61	7,9
806-1200	807-1200	M12	88	35	35	12	26	15	73	9,9
806-1600	807-1600	M16	112	44	40	16	34	19	93	11,9
806-2000	807-2000	M20	140	55	40	20	42	24	116	14,9
806-2400	807-2400	M24	168	68	40	22	52	30	138	17,9

Material 1.4404

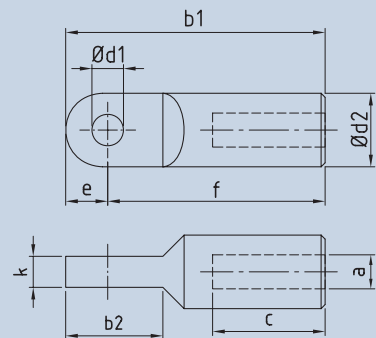

Eye bolt

Part number RH thread	Part number LH thread	a	b	c1	c2	ø d1	ø d2	k
888-0600-01	888-0600-02	M6	40	18		6,1	14	7
888-0800-01	888-0800-02	M8	40	22		8,1	18	9
888-1000-01	888-1000-02	M10	50	26		10	20	12
888-1200-01	888-1200-02	M12	50	30		12,1	25	14
888-1600-01	888-1600-02	M16	60	38		16,1	32	17
888-2000-01	888-2000-02	M20	80	46		18,1	40	22
888-0600-03	888-0600-04	M6	40		30	6,1	14	7
888-0800-03	888-0800-04	M8	40		30	8,1	18	9
888-1000-03	888-1000-04	M10	50		40	10	20	12
888-1200-03	888-1200-04	M12	50		35	12,1	25	14
888-1600-03	888-1600-04	M16	60		40	16,1	32	17
888-2000-03	888-2000-04	M20	80		55	18,1	40	22

Material 1.4301

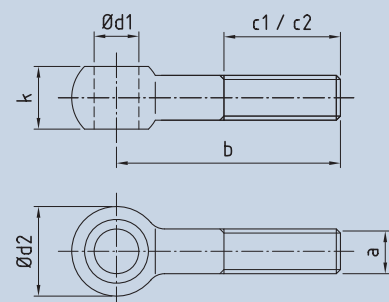

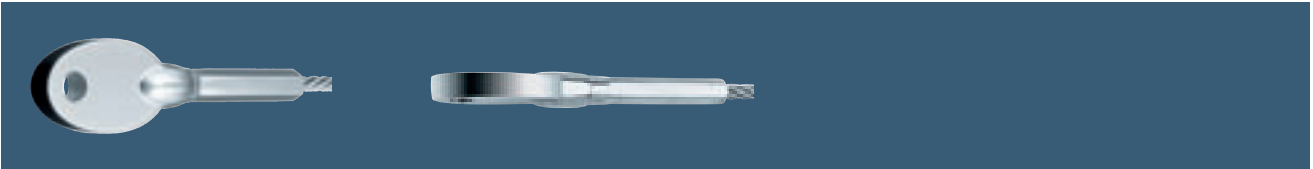

CS-Eye swaged

Part number	ø rope	b	ø d1	ø d2	e	k	f	h	kN
980-0400	4	78	7,8	6	8	6	19	20	11,8
980-0500	5	78	7,8	6	8	6	19	20	12
980-0600	6	106	9,8	8	10	8	23	24,5	16,5

Material 1.4401 | CS-Eye is compatible with CS-Fork

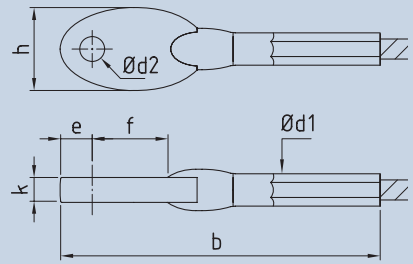

Eye swaged

Part number	ø rope	b1	b2	ø d1	ø d2	e	h	k	kN
880-0200	2	57	16	5,5	5,5	6,5	12,5	3	2,9
880-0300	3	62	17	6,3	6,5	6,5	13,5	4	6,7
880-0400	4	77	22	7,5	8,5	9	17	5	11,9
880-0500	5	87	27	9	10,5	11	21	6	18,5
880-0600	6	108	29	12,5	13	12,5	25	8	26,7
880-0800	8	133	37	16	14,5	15	30	10	44,5
880-1000	10	159	45	17,8	16,3	18	35	11	69,5
880-1200	12	181	49	20	19,3	20	40	15	93,6
880-1400	14	213	63,6	25	22,5	25,5	41	20	117,9
880-1600	16	245	72	28,2	25,5	31,7	44	24	158,4

Material 1.4401

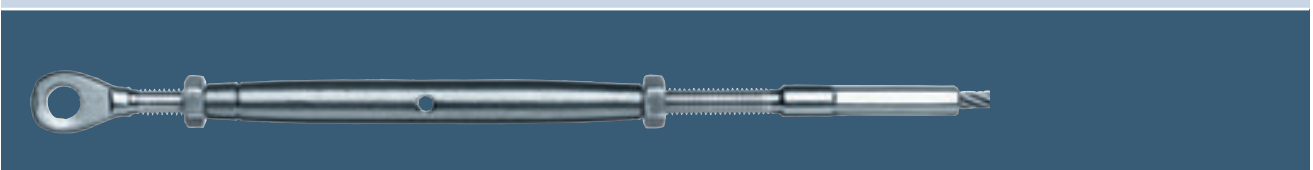
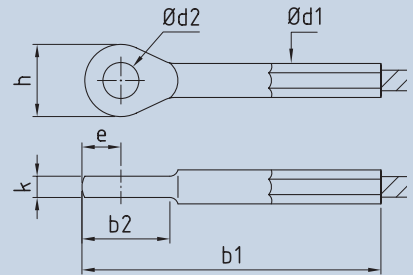

Turnbuckle with eye swaged

Part number	ø rope	a	b	ø d1	ø d2	Adjustment	kN
889-0200	2	M5	193	5	5,5	+26 -43	2,9
889-0300	3	M6	215	6	6,5	+28 -50	6,7
889-0400	4	M6	220	7	6,5	+28 -50	11,9
889-0401	4	M8	248	8	8,5	+34 -50	11,9
889-0500	5	M8	254	8	8,5	+34 -50	18,5
889-0600	6	M10	288	10	10,5	+30 -50	26,7
889-0800	8	M12	368	13	13	+46 -70	44,5
889-1000	10	M16	490	18	14,5	+48 -90	69,5
889-1200	12	M20	570	20	19,5	+60 -105	93,6

Material 1.4401

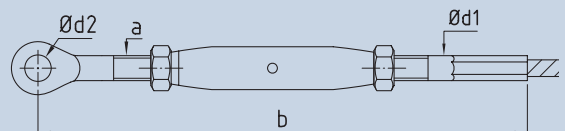

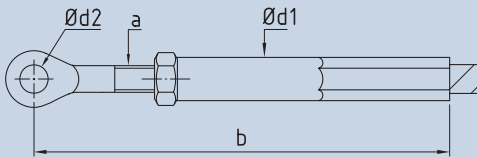

Eye with internal thread swaged

Part number RH thread	Part number LH thread	ø rope	a	b	ø d1	ø d2	Adjustment	kN
814-0300-01	813-0300-01	3	M5	100	7	5,5	+5 -10	6,7
814-0300-02	813-0300-02	3	M5	136	7	5,5	+12 -17	6,7
814-0400-01	813-0400-01	4	M6	106	8	6,5	+4 -10	11,8
814-0400-02	813-0400-02	4	M6	135	8	6,5	+11 -17	11,8
814-0500-01	813-0500-01	5	M6	110	8	6,5	+4 -10	12
814-0500-02	813-0500-02	5	M6	145	8	6,5	+11 -17	12
814-0600-01	813-0600-01	6	M8	135	10	8,5	+4 -12	16,5
814-0600-02	813-0600-02	6	M8	173	10	8,5	+17 -25	16,5
814-0800-01	813-0800-01	8	M10	248	13	10,5	+17 -27	26
814-1000-01	813-1000-01	10	M14	295	20	13	+26 -40	69,5
814-1200-01	813-1200-01	12	M16	345	25	14,5	+26 -42	93,6
814-1600-01	813-1600-01	16	M20	410	32	19,3	+30 -50	159

Material 1.4401





Eye STA-LOK® swageless connection

Part number	ø rope	ø d	h	e	f	k	kN
853-0300	3	6,5	17,9	6,3	10	5	6,7
853-0400	4	8	20,3	8	14,7	5,8	11,9
853-0500	5	10	25,9	10,5	18	7,5	18,5
853-0600	6	13	31	12,7	22	9,4	26,7
853-0800	8	13	35,7	14,4	27	12	44,5
853-1000	10	16	41,1	17,8	29,2	13,4	69,5
853-1200	12	19,5	42,9	22,5	33,3	19	93,6
853-1400	14	22,5	55,6	25,5	38,1	20	117
853-1600	16	22,5	63,8	27,1	40	20	158
853-1900	19	28,6	68,3	36,5	49,2	27	209
853-2200	22	34,9	122,2	39,7	60,3	33,3	269
853-2600	26	34,9	128,6	42,9	60,3	33,3	374

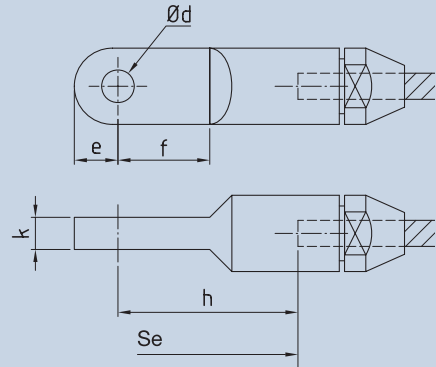

Material 1.4401 | Standard: cone for strand 1 x 19

**ISL-STA-LOK® Cones
Strand 1 x 19**

Part number	ø rope
ISL12.60.03	3
ISL12.60.04	4
ISL12.60.05	5
ISL12.60.06	6
ISL12.60.08	8
ISL12.60.10	10
ISL12.60.12	12
ISL12.60.14	14
ISL12.60.16	16
ISL12.60.19	19
ISL12.60.22	22
ISL12.60.26	26

**ISL-STA-LOK® Cones
Compact strand 1 x 19**

Part number	ø rope
ISL15.40.04	4
ISL15.40.05	5
ISL15.40.06	6
ISL15.40.08	8
ISL15.40.10	10
ISL15.40.12	12
ISL15.40.14	14
ISL15.40.16	16

**ISL-STA-LOK® Cones
Rope 7 x 7 | 7 x 19**

Part number	ø rope
ISL12.70.04	4
ISL12.70.05	5
ISL12.70.06	6
ISL12.70.08	8
ISL12.70.10	10
ISL12.70.12	12
ISL12.70.14	14
ISL12.70.16	16



BW-Eye swageless connection

Part number	ø rope	k	ø d	l1	l2	kN
753-0300	3	5,5	6,3	58	50	7
753-0400	4	7	8,3	68	58	13
753-0500	5	8	10,3	81	70	20
753-0600	6	9	12,3	97	83	29
753-0800	8	10,5	14,3	121	103	52
753-1000	10	13	16,3	133	114	82
753-1200	12	15	19,5	155	132	118

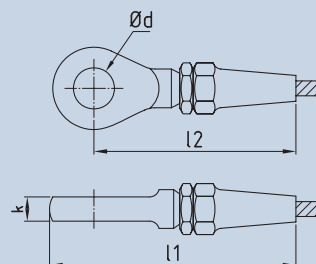

Material 1.4401

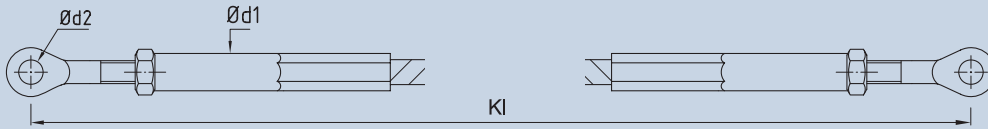
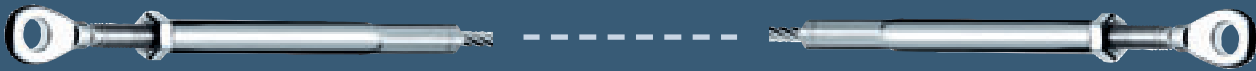

Both sides eye with internal thread swaged

Part number	ø rope	Sk	Thread	Adjustment	ø d1	ø d2
IK 400-0300	3	7 x 7	M5	+10 -20	7	5,5
IK 400-0301	3	7 x 7	M5	+24 -34	7	5,5
IK 400-0400	4	7 x 7	M6	+8 -20	8	6,5
IK 400-0401	4	7 x 7	M6	+22 -34	8	6,5
IK 400-0500	5	7 x 7	M6	+8 -20	8	6,5
IK 400-0501	5	7 x 7	M6	+22 -34	8	6,5
IK 400-0600	6	7 x 7	M8	+8 -24	10	8,5
IK 400-0601	6	7 x 7	M8	+34 -50	10	8,5
IK 400-0800	8	7 x 7	M10	+34 -54	13	10,5
IK 400-1000	10	7 x 19	M14	+52 -80	20	13
IK 400-1200	12	7 x 19	M16	+52 -84	25	14,5
IK 400-1600	16	7 x 19	M20	+60 -100	32	19,3

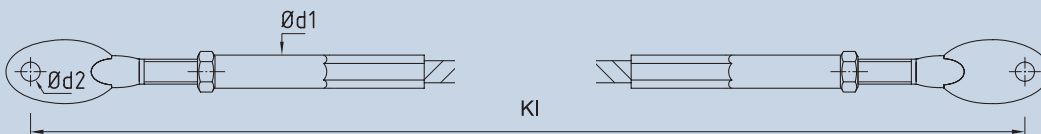

Both sides CS-Eye with internal thread swaged

Part number	ø rope	Sk	Thread	Adjustment	ø d1	ø d2
IK 405-0400	4	7 x 7	M6	+14 -22	8	6
IK 405-0500	5	7 x 7	M6	+14 -22	8	6
IK 405-0600	6	7 x 7	M8	+22 -42	10	8
IK 405-0800	8	7 x 7	M10	+22 -42	13	8

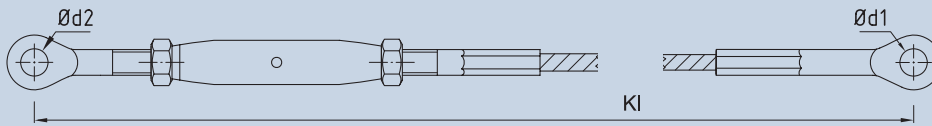

One side turnbuckle with eye, other side with eye swaged

Part number	\varnothing rope	Sk	Thread	Adjustment	$\varnothing d1$	$\varnothing d2$
IK 410-0200	2	7 x 7	M5	+26 -43	5,5	5,5
IK 410-0300	3	7 x 7	M6	+28 -50	6,5	6,5
IK 410-0400	4	7 x 7	M6	+28 -50	8,5	6,5
IK 410-0401	4	7 x 7	M8	+34 -50	8,5	8,5
IK 410-0500	5	7 x 7	M8	+34 -50	10,5	8,5
IK 410-0600	6	7 x 7	M10	+30 -50	13	10,5
IK 410-0800	8	7 x 7	M12	+46 -70	14,5	13
IK 410-1000	10	7 x 19	M16	+48 -90	16,3	14,5
IK 410-1200	12	7 x 19	M20	+60 -105	19,3	19,5

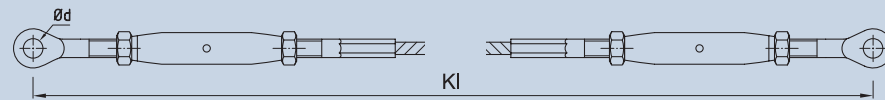

Both sides turnbuckle with eye swaged

Part number	\varnothing rope	Sk	Thread	Adjustment	$\varnothing d$
IK 420-0200	2	7 x 7	M5	+52 -86	5,5
IK 420-0300	3	7 x 7	M6	+56 -100	6,5
IK 420-0400	4	7 x 7	M6	+56 -100	6,5
IK 420-0401	4	7 x 7	M8	+68 -100	8,5
IK 420-0500	5	7 x 7	M8	+68 -100	8,5
IK 420-0600	6	7 x 7	M10	+60 -100	10,5
IK 420-0800	8	7 x 7	M12	+92 -140	13
IK 420-1000	10	7 x 19	M16	+96 -180	14,5
IK 420-1200	12	7 x 19	M20	+120 -210	19,5

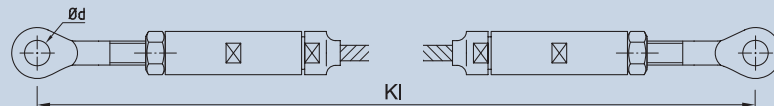

Both sides eye with internal thread swageless connection

Part number	\varnothing rope	Sk	Thread	Adjustment	$\varnothing d$
IK 430-0200	2	7 x 7	M6	+8 -20	6,5
IK 430-0300	3	7 x 7	M6	+8 -20	6,5
IK 430-0400	4	7 x 7	M6	+8 -20	6,5
IK 430-0500	5	7 x 7	M8	+8 -20	8,5
IK 430-0600	6	7 x 7	M8	+8 -20	8,5
IK 430-0800	8	7 x 7	M10	+10 -40	10,5
IK 430-1000	10	7 x 19	M14	+30 -60	13
IK 430-1200	12	7 x 19	M16	+30 -60	14,5



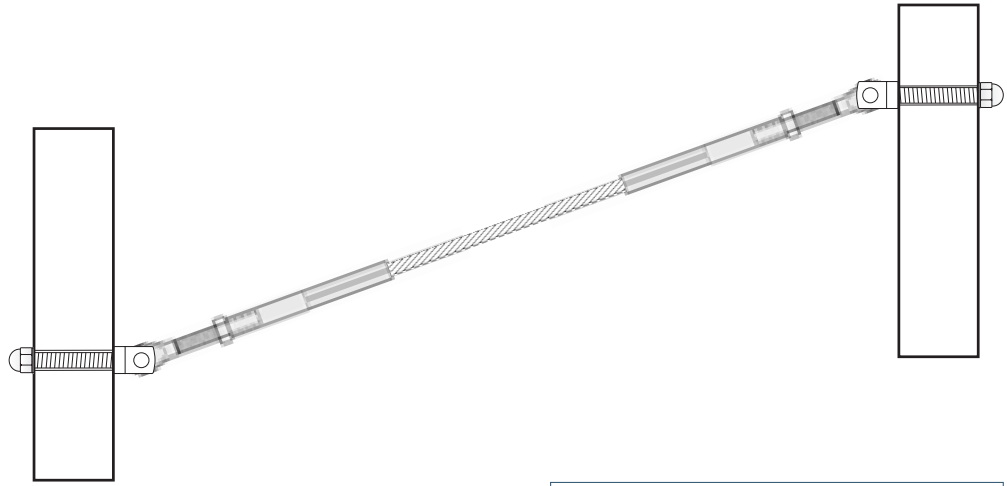

Assemblies with eye can be combined with eye counterpieces.

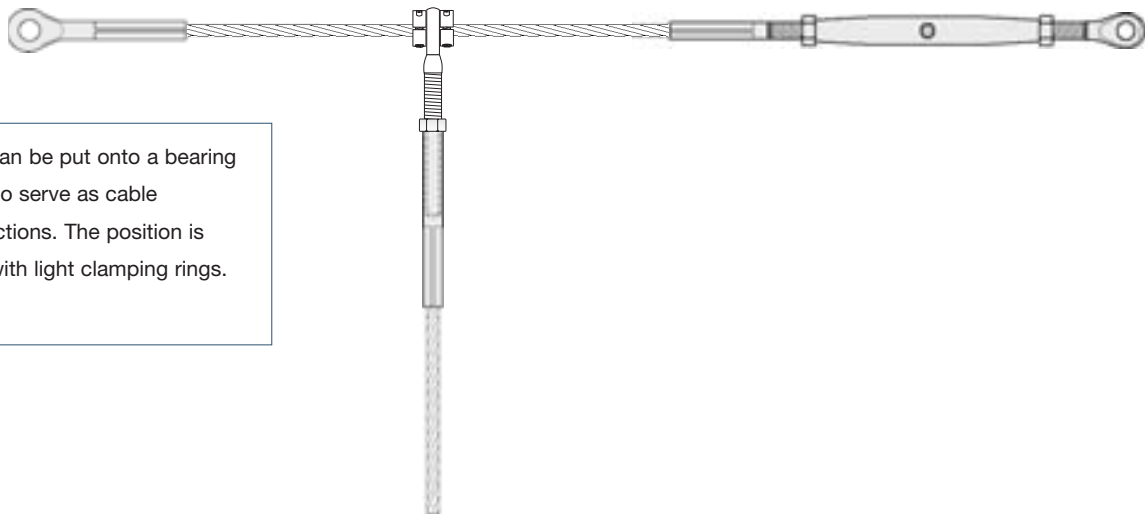

Eyes can be put onto a bearing cable to serve as cable connections. The position is fixed with light clamping rings.

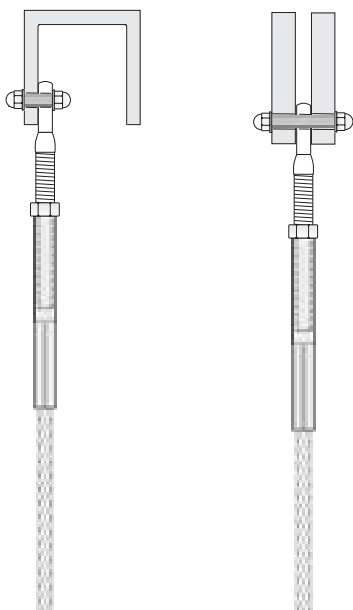

Eyes with external thread serve to guide the cable, light clamping rings distribute the tensile forces.

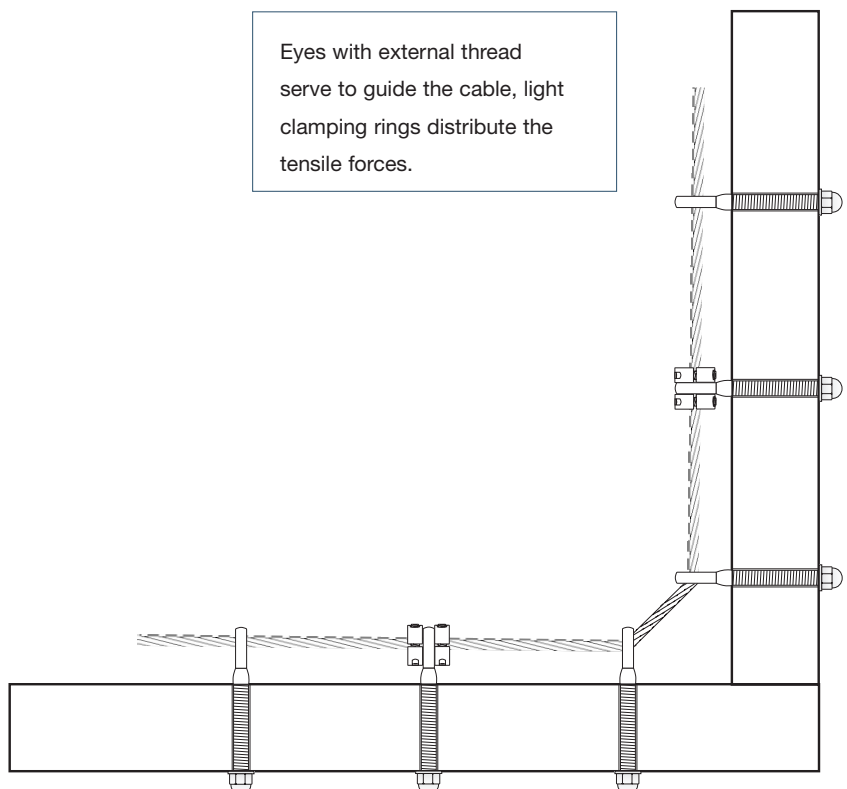

Assemblies with eyes allow connection to standard profiles.





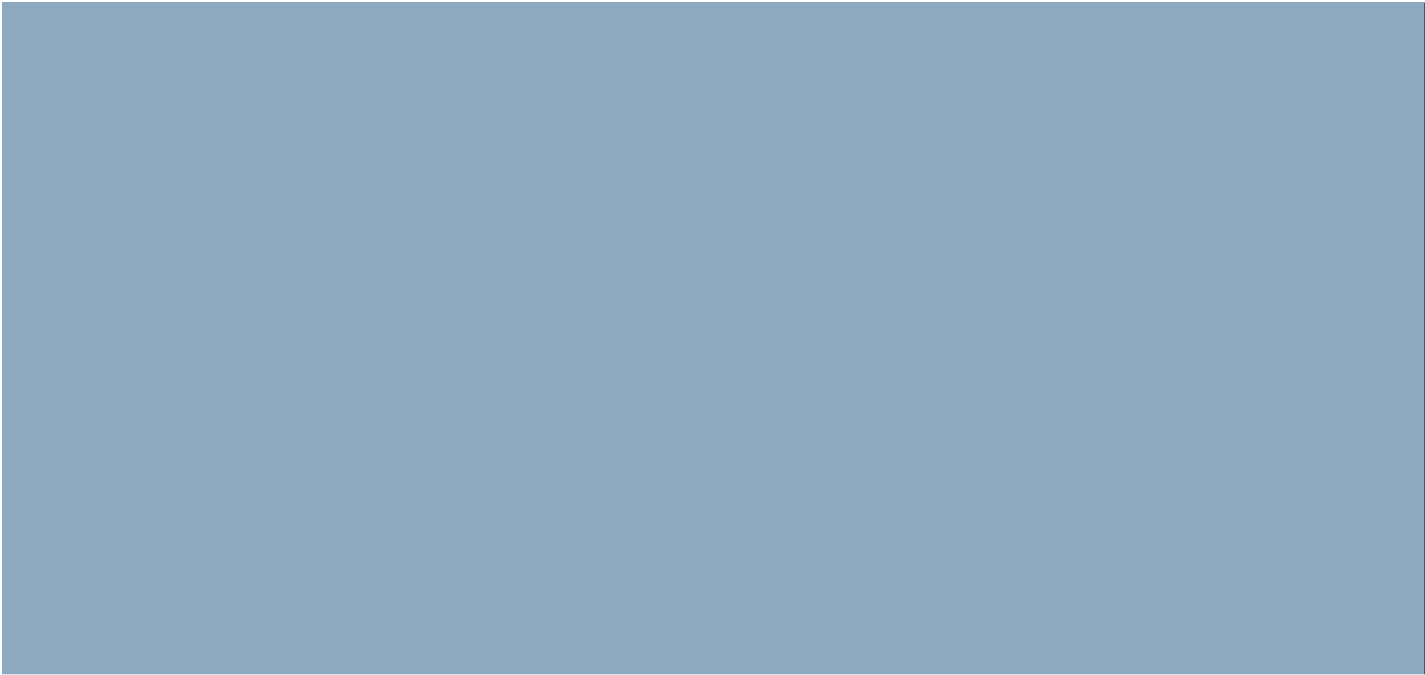



I-SYS: End Stops

End stops ensure secure fixing. Along with preformed parts they offer secure connections for sloping cable runs. Balls and sockets are also among the exceptional products offered in the I-SYS range. This rounded duo is a technical innovation for end connections at angles of slope of up to 60 degrees and is the subject of a current patent application. The principle of movement between ball and socket originates from nature: the ball sits firmly on the socket, which is round and therefore invariably fits. Rapid and formally consistent solutions which fit flexibly into the angle are the result.

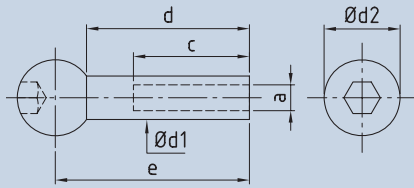

Ball head with internal thread

Part number	a	Ød1	c	d	e	Ød2
868-0400	M4	6	15	25	31,3	14
868-0500	M5	7	20	30	36	14
868-0600	M6	8	20	30	35,7	14

Material: 1.4401

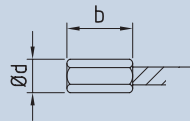

End stop swaged

Part number	Ø rope b	Ø d	kN
865-0200	2 12	8	2
865-0300	3 15	8	4,5
865-0400	4 20	13	8,1
865-0500	5 20	13	12,6
865-0600	6 30	18	18,1
865-0800	8 40	18	23,2

Material 1.4404

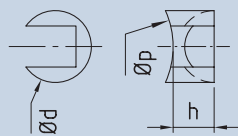

Pivot base for ball head

Part number	Ø d	h	Ø tube p
868-034	14	9,5	33,7
868-043	14	9,5	42,4
868-060	14	9,5	60

Material 1.4401 | for round profile

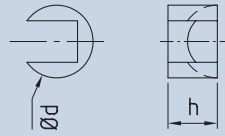

Pivot base for ball head

Part number	Ø d	h
868-456	14	9,5

Material 1.4401 | for flat profile

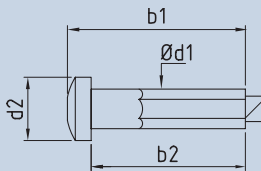

Swage radiused head end stop

Part number	Ø rope	b1	b2	Ø d1	Ø d2	kN
869-0200	2	24	21	5	8	2,9
869-0300	3	35	31	6	10	6,7
869-0400	4	40	36	7	12	11,9
869-0500	5	47	42	8	14	18,5
869-0600	6	58	52	10	16	26,7
869-0800	8	70	62	13	22	44,5

Material 1.4404

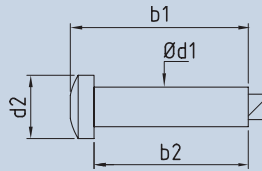

Low profile swaged radius head end stop

Part number	Ø rope	b1	b2	Ø d1	Ø d2	kN
869-0200-04	2	9,08	6,2	3	6	1,6
869-0300-04	3	10,83	9	4,5	8	3,5
869-0400-04	4	14,09	12	5	10	6,3
869-0500-04	5	19,35	16	6	12	9,8
869-0600-04	6	24,14	18	8	16	14,1
869-0800-04	8	29,51	23,5	10,2	20	25,1

Material 1.4404



Radius head end stop with internal thread right hand

Part number	a	b1	b2	c	ø d1	ø d2
869-0400-02	M4	29	25	15	6	10
869-0500-02	M5	34	30	20	7	12
869-0600-02	M6	35	30	20	8	14
869-0800-02	M8	40	34	25	10	16

Material 1.4404

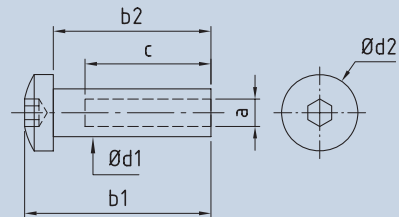

90° countersunk stop with internal thread right hand

Part number	a	b1	b2	c	ø d1	ø d2	k1	k2
866-0400-02	M4	30,2	26	15	6	10,4	2,2	2
866-0500-02	M5	33,7	30	20	7	10,4	1,7	2
866-0600-02	M6	34,2	30	20	8	12,4	2,2	2
866-0800-02	M8	40,2	37	25	10	12,4	1,2	2

Material 1.4404

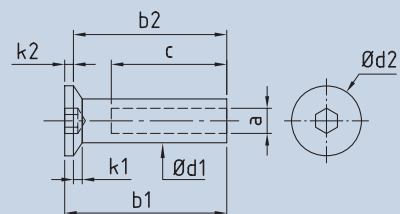

Low profile swaged radius head end stop 90°

Part number	ø rope	b1	b2	ø d1	ø d2	kN
866-0200-04	2	8,7	6,2	3	6	1,6
866-0300-04	3	10	9	4,5	8	3,5
866-0400-04	4	13,5	12	5	10	6,3
866-0500-04	5	18,3	15	6	12	9,8
866-0600-04	6	22,4	18	8	16	14,1
866-0800-04	8	27,4	23,5	10,2	20	25,1

Material 1.4404

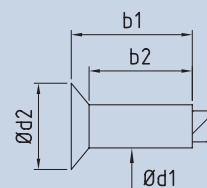

Swage end stop 90° countersunk head

Part number	ø rope	b1	b2	ø d1	ø d2	k1	k2	kN
866-0200	2	24,2	21	5	8,3	1,7	1,5	2,9
866-0300	3	35,2	31	6	10,4	2,2	2	6,7
866-0400	4	39,7	36	7	10,4	1,7	2	11,9
866-0500	5	46,2	42	8	12,4	2,2	2	18,9
866-0600	6	55,2	52	10	12,4	1,2	2	26,7
866-0800	8	68,8	62	13	20,5	3,8	3	44,5

Material 1.4404

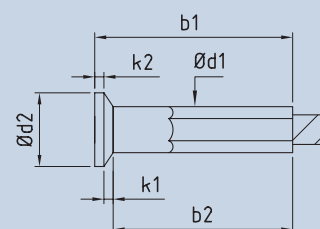

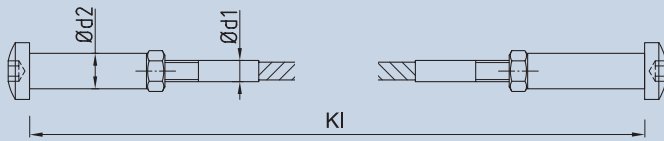

Both sides with external thread F30 and swageless-on radiused end stop

Part number	\varnothing rope	Sk	Thread	Adjustment	\varnothing d1	\varnothing d2
IK 170-0400	4	7 x 7	M5	+6 -24	4,9	7
IK 170-0500	5	7 x 7	M6	+6 -22	5,9	8
IK 170-0600	6	7 x 7	M8	+8 -26	7,9	10

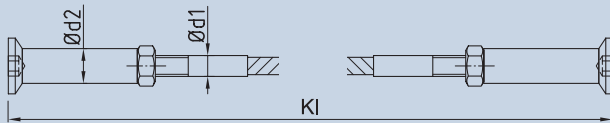

Both sides with external thread F30 and swageless-on countersunk end stops

Part number	\varnothing rope	Sk	Thread	Adjustment	\varnothing d1	\varnothing d2
IK 180-0400	4	7 x 7	M5	+6 -24	4,9	7
IK 180-0500	5	7 x 7	M6	+6 -22	5,9	8
IK 180-0600	6	7 x 7	M8	+8 -26	7,9	10

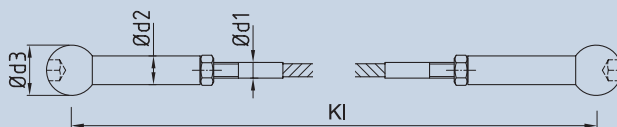

Both sides with external thread F30 and swageless-on ball head

Part number	\varnothing rope	Sk	Thread	Adjustment	\varnothing d1	\varnothing d2	\varnothing d3
IK 190-0300	3	7 x 7	M4	+4 -15	3,9	6	14
IK 190-0400	4	7 x 7	M5	+5 -20	4,9	7	14
IK 190-0500	5	7 x 7	M6	+5 -20	5,9	8	14

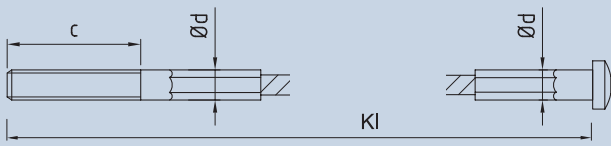

One side external thread swaged, other side radiused head end stop swaged

Part number	Ø rope	Sk	Thread size x length c	Ø d
IK 150-0200	2	7 x 7	M5 x 30	5
IK 150-0201	2	7 x 7	M5 x 60	5
IK 150-0300	3	7 x 7	M6 x 30	6
IK 150-0301	3	7 x 7	M6 x 60	6
IK 150-0400	4	7 x 7	M6 x 30	7
IK 150-0401	4	7 x 7	M6 x 60	7
IK 150-0500	5	7 x 7	M8 x 30	8
IK 150-0501	5	7 x 7	M8 x 60	8
IK 150-0600	6	7 x 7	M10 x 30	10
IK 150-0601	6	7 x 7	M10 x 60	10
IK 150-0800	8	7 x 7	M12 x 80	13

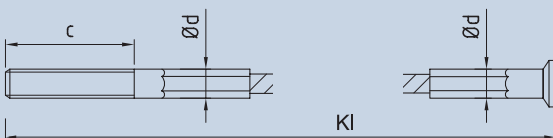
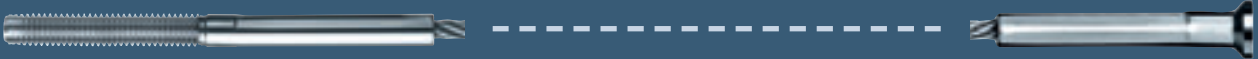

One side external thread swaged, other side countersunk end stop swaged

Part number	Ø rope	Sk	Thread size x length c	Ø d
IK 160-0200	2	7 x 7	M5 x 30	5
IK 160-0201	2	7 x 7	M5 x 60	5
IK 160-0300	3	7 x 7	M6 x 30	6
IK 160-0301	3	7 x 7	M6 x 60	6
IK 160-0400	4	7 x 7	M6 x 30	7
IK 160-0401	4	7 x 7	M6 x 60	7
IK 160-0500	5	7 x 7	M8 x 30	8
IK 160-0501	5	7 x 7	M8 x 60	8
IK 160-0600	6	7 x 7	M10 x 30	10
IK 160-0601	6	7 x 7	M10 x 60	10
IK 160-0800	8	7 x 7	M12 x 80	13

End Stops | Assembly

Possible connections and combinations for end stops in rectangular situations.

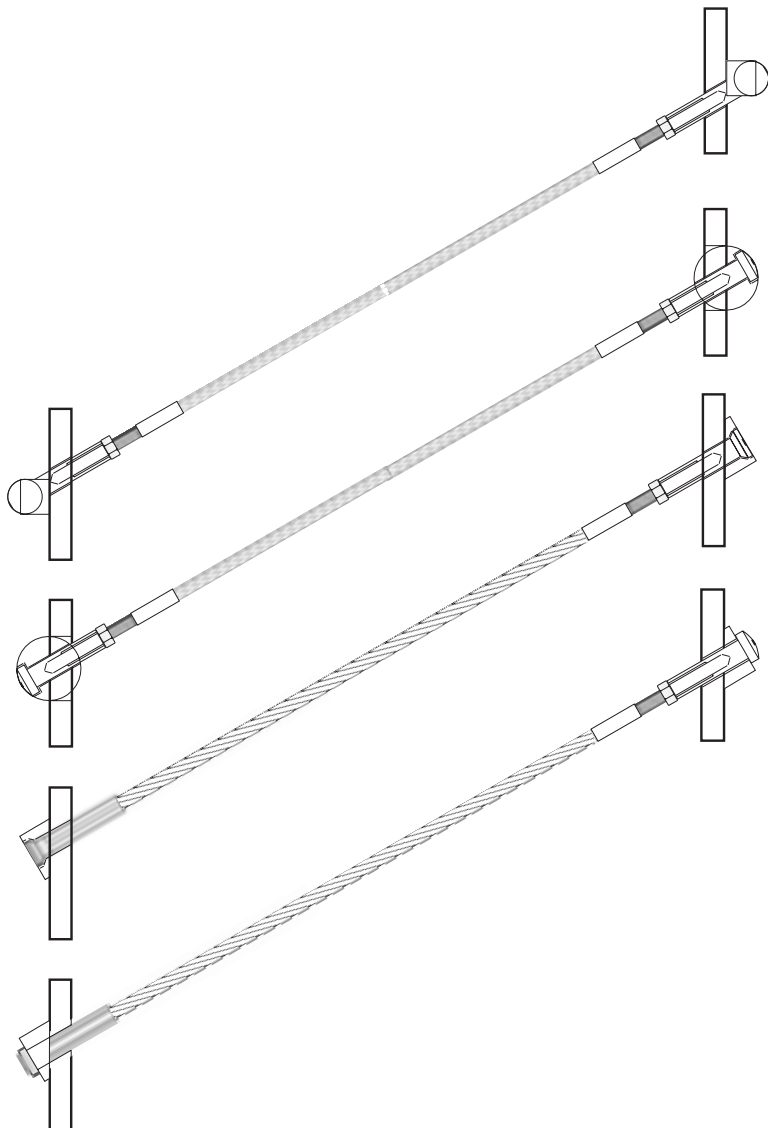
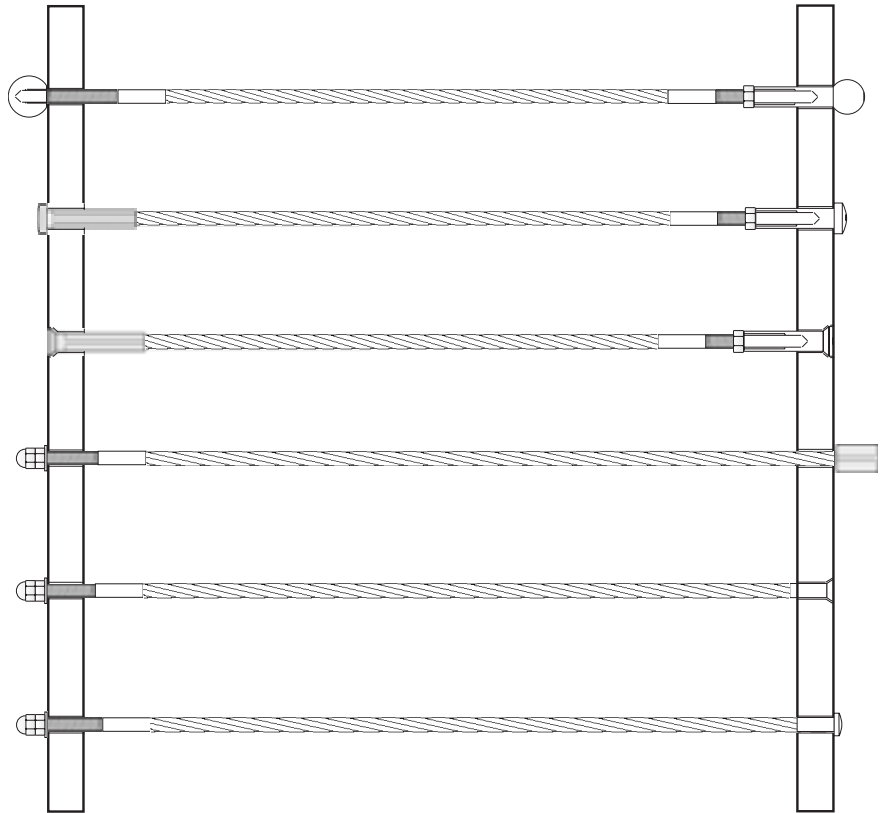

Possible connections and combinations for end stops in angled situations.











I-SYS: Cables, Loops, Clamps, Accessories

Stainless steel cables are some of the most adaptable elements within architecture. Of static significance or decorative, fine or functional, discreetly integrated or designed to be eye-catching - cables really add to the creative possibilities of building. With diameters of between 1 and 26 millimetres and end connections from M4 to M36, I-SYS offers the right range for individual applications. With I-SYS, the formal unit of cable and connection becomes a perfect architectural detail.

Ready-assembled or ready to assembly – Carl Stahl follows the individual wishes of its clients. For the end result is what matters. The professional team of I-SYS advisors will find suitable solutions for all questions of planning, pre-assembly, manufacture and final erection and assembly.



Strand 1 x 19

Part number	ø	kN	MQ mm ²
810-0200	2	3,30	2,39
810-0300	3	7,42	5,37
810-0400	4	13,20	9,55
810-0500	5	20,60	14,92
810-0600	6	29,70	21,49
810-0800	8	49,40	38,20
810-1000	10	77,20	59,69
810-1200	12	104	85,95
810-1400	14	131	116,99
810-1600	16	176	152,81
810-1900	19	233	215,48
810-2200	22	299	288,90
810-2600	26	416	403,51

Material 1.4401



Strand 1 x 37 | 1 x 61*

Part number	ø	kN	MQ mm ²
610-1600	16	184,6	150,8
610-1800	18	227,5	190,8
610-2200*	22	322	285,1
610-2600*	26	445	398,2

Material 1.4401



Compact strand 1 x 19

Part number	ø	kN	MQ mm ²
0153.10.80CS	8	61,76	46,24
0153.11.00CS	10	98,04	72,26
0153.11.20CS	12	142,15	104,05

Material 1.4401



Compact strand 1 x 36

Part number	ø	kN	MQ mm ²
0153.11.40CS	14	194,11	140,08
0153.11.60CS	16	253,92	182,97

Material 1.4401



Rope 7 x 7

Part number	ø	kN	MQ mm ²
820-0100	1	0,56	0,43
820-0200	2	2,24	1,71
820-0300	3	5,03	3,85
820-0400	4	8,94	6,85
820-0500	5	14	10,70
820-0600	6	20,10	15,42
820-0800	8	35,80	27,40

Material 1.4401



Rope 7 x 19

Part number	ø	kN	MQ mm ²
830-0200	2	2,84	1,66
830-0300	3	4,69	3,73
830-0400	4	8,34	6,63
830-0500	5	13	10,36
830-0600	6	18,8	14,92
830-0800	8	33,4	26,53
830-1000	10	52,1	41,45
830-1200	12	75,1	59,69
830-1400	14	102	81,25
830-1600	16	133	106,12
830-2000*	20	207	182,21

Material 1.4401 | *6 x 36 WS + IWRC



Rod with both sides external thread

Part number	ø	Thread size x length c	kN*
IS-625	6	M6 x 25	3,88
IS-830	8	M8 x 30	7,08
IS-1040	10	M10 x 40	11,22
IS-1250	12	M12 x 50	16,31
IS-1660	16	M16 x 60	30,38

Material 1.4401/1.4571 | Rod length maximum 2 m
*permissible load

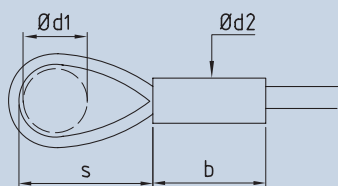

Loop swaged without thimble

Part number	ø rope	s	b	ø d1	ø d2	kN
801-0200	2	30	10	x	4	2
801-0300	3	45	15	x	6	4,5
801-0400	4	60	20	x	8	8,1
801-0500	5	75	25	x	10	12,6
801-0600	6	90	30	x	12	18,1
801-0800	8	120	40	x	16	32,2
801-1000	10	150	50	x	20	46,9
801-1200	12	180	60	x	24	67,6
801-1400	14	210	70	x	28	91,8
801-1600	16	240	80	x	32	119,7

Alu-ferrule | Dimension ø d1 variable
Not suitable for strands

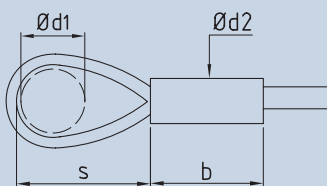

Loop swaged without thimble

Part number	ø rope	s	b	ø d1	ø d2	kN
803-0200	2	30	10	x	4	2
803-0300	3	45	13	x	6	4,5
803-0400	4	60	16	x	8	8,1
803-0500	5	75	20	x	10	12,6
803-0600	6	90	28	x	12	18,1
803-0800	8	120	40	x	16	32,2
803-1000	10	150	50	x	20	46,9
803-1200	12	180	60	x	24	67,6
803-1400	14	210	70	x	28	91,8
803-1600	16	240	80	x	32	119,7

Inox-ferrule | Material 1.4404 | Dimension ø d1 variable
Not suitable for strands

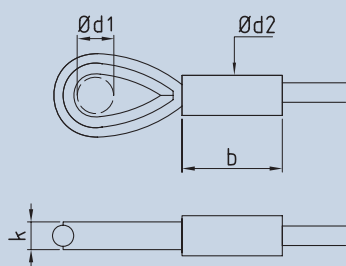

Loop swaged with thimble

Part number	ø rope	b	ø d1	ø d2	k	kN
802-0200	2	10	6,5	5	4	2
802-0300	3	15	9,5	7	5,5	4,5
802-0400	4	20	10,5	9	6,5	8,1
802-0500	5	25	12,5	12	8	12,6
802-0600	6	30	15,5	13	9	18,1
802-0800	8	40	17,5	18	12	32,2
802-1000	10	50	23,5	22	14	46,9
802-1200	12	60	25,5	26	20	67,6
802-1400	14	70	33,5	32	22	91,8
802-1600	16	80	36,5	36	24	119,7

Alu-ferrule | Not suitable for strands

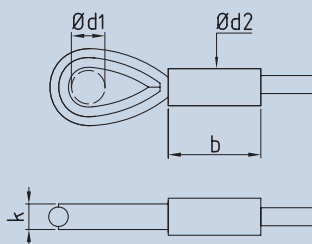

Loop swaged with thimble

Part number	ø rope	b	ø d1	ø d2	k	kN
804-0200	2	10	6,5	7	4	2
804-0300	3	13	9,5	9	5,5	4,5
804-0400	4	16	10,5	13	6,5	8,1
804-0500	5	20	12,5	15	8	12,6
804-0600	6	28	15,5	13	9	18,1
804-0800	8	40	17,5	16	12	32,2
804-1000	10	50	23,5	20	14	46,9
804-1200	12	60	25,5	24	20	67,6
804-1400	14	70	33,5	28	22	91,8
804-1600	16	80	36,5	32	24	119,7

Inox-ferrule | Material 1.4404
Not suitable for strands



Loop clamp ring with thimble

Part number	ø rope	a	b	ø d1	ø d2	k	kN
874-0300	3	M4	27	22	9,5	5,5	4,9
874-0400	4	M4	27	22	10,5	6,5	5,1
874-0500	5	M4	42	28	12,5	8	7,8
874-0600	6	M4	42	28	15,5	9	12
874-0800	8	M4	42	28	17,5	12	13

Material 1.4401 | Not suitable for strands

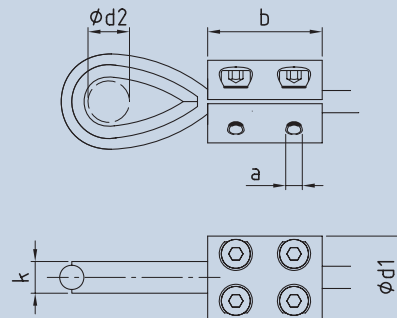

Light clamp ring with thimble

Part number	ø rope	a	b	ø d1	ø d2	k	kN
874-0200-01	2	M3	10	15	6,5	4	1,1
874-0300-01	3	M3	10	15	9,5	5,5	2,4
874-0400-01	4	M4	10	20	10,5	6,5	4

Material 1.4401 | Not suitable for strands

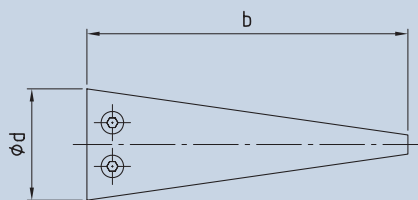
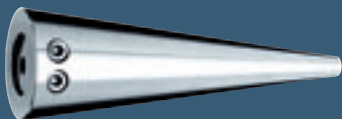
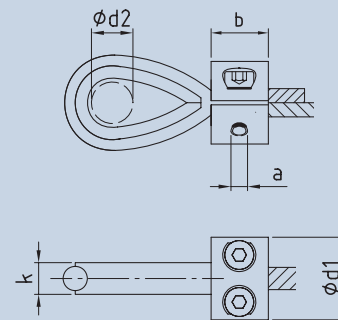

Rope clamp cone

Part number	ø rope	F ax	b	ø d
859-0300-03	3	1,3	90	30
859-0400-03	4	1,5	90	30

Material 1.4401 | Not suitable for strands



Cover disk for rope clamp cone

Part number	ø d1	ø d2	k
859-03-04	30	4,5	4

Material 1.4571

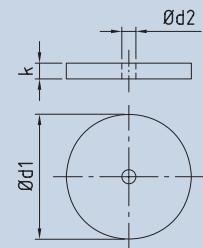

Cross clamp with connection

Part number	ø rope	l1	l2	ø d
858-0400-04	3/4	28	15	25
858-0600-04	5/6	32	15	25

Material 1.4401

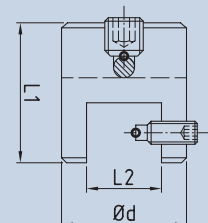

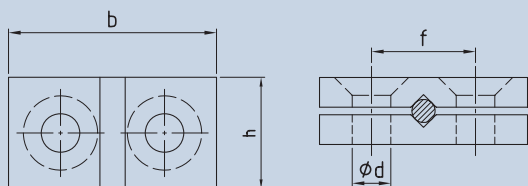

Two part side clamp

Part number	ø rope	b	h	f	ød
833-0200	2	28	15	14	5,2
833-0300	3	28	15	14	5,2
833-0400	4	28	15	14	5,2
833-0500	5+6	28	15	14	5,2

Material 1.4404 | Not suitable for strands

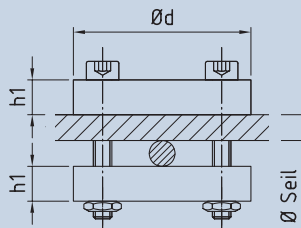

CS-Cross clamp adjustable

Part number	ø rope	ød	h1	h2
858-36	4-6	36	6	6
858-42	8-12	42	8	8



Material 1.4401

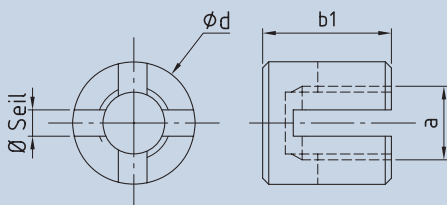

Cross clamp 90°

Part number	ø rope	a	b1	ød
858-0200	2	M12	18	20
858-0300	3	M12	19	20
858-0400	4	M12	21	20
858-0500	5	M12	23	20
858-0600	6	M12	25	20



Material 1.4401

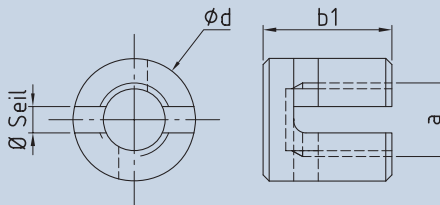

Cross clamp adjustable

Part number	ø rope	a	b1	ød
858-0200-01	2	M12	15,5	20
858-0300-01	3	M12	17,5	20
858-0400-01	4	M12	19,5	20
858-0500-01	5	M12	21,5	20
858-0600-01	6	M12	23,5	20



Material 1.4401



Cross clamp with internal thread adjustable

Part number	ø rope	a1	a2	b1	ød	c
858-0200-02	2	M12	M8	27	20	15
858-0300-02	3	M12	M8	29	20	15
858-0400-02	4	M12	M8	31	20	15
858-0500-02	5	M12	M8	33	20	15
858-0600-02	6	M12	M8	35	20	15



Material 1.4401

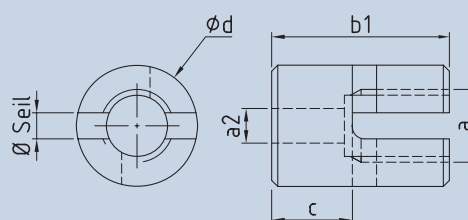

Clamps

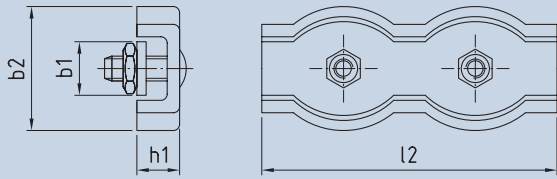

Duplex clamp

Part number	ørope	b1	b2	h1	l2
5865-00-02	2	4	12	5	30
5865-00-03	3	6	14	7	35
5865-00-04	4	8	18	7	40
5865-00-05	5	10	20	8	50
5865-00-06	6	12	24	9	60
5865-00-08*	8	17	30	13	75
5865-00-10*	10	21	35	16	95

Material 1.4301 | Not suitable for strands

*Only suitable for rope 7 x 19

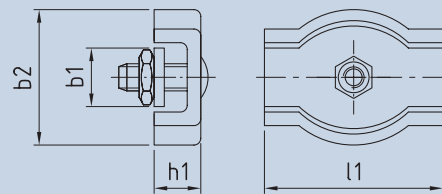

Simplex clamp

Part number	ørope	b1	b2	l1
5855-00-02	2	4	12	15
5855-00-03	3	6	14	17
5855-00-04	4	8	18	20
5855-00-05	5	10	20	25
5855-00-06	6	12	24	30
5855-00-08*	8	17	30	37

Material 1.4301 | Not suitable for strands

*Only suitable for rope 7 x 19

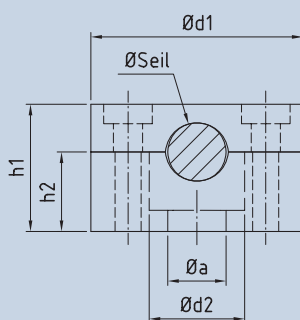

Screw on cross clamp

Part number	ørope	ød1	ød2	h1	h2	øa
858-0800-06	8	40	15	25	15	8,3
858-1000-06	10	40	15	25	15	8,3
858-1200-06	12	40	15	25	15	8,3
858-1600-06	16	46	18	32	19,5	10,3



Material 1.4404

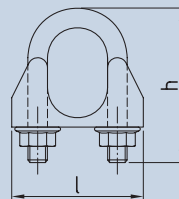

Wire rope grip

Part number	Grips		h	l
	ørope	per Loop		
800-0200	2	3	18	14
800-0300	3	3	24	17
800-0400	4	3	24	19
800-0500	5	4	33	24
800-0600	6	4	33	28
800-0800	8	4	40	34
800-1000	10	4	50	45
800-1200	12	4	60	51
800-1400	14	4	65	53
800-1600	16	4	75	60

Material 1.4401 | Not suitable for strands





Clamp ring

Part number	ørope	F ax	a	b	ø d1
873-0300	3	3	M4	27	22
873-0400	4	3,6	M4	27	22
873-0500	5	5,8	M5	42	28
873-0600	6	6,5	M5	42	28
873-0800	8	9,4	M5	42	28

Material 1.4401 | Not suitable for strands

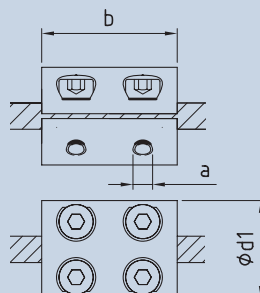

Light clamp ring with adapter

Part number	ørope	F ax	ø b	ø d	h	a
863-0200-02	2	1	15	30	11,5	M3
863-0300-02	3	1,3	15	30	11,5	M3
863-0400-02	4	1,5	15	30	11,5	M3
863-0500-02	5	2	20	35	11,5	M4
863-0600-02	6	2,2	20	35	11,5	M4
863-0800-02	8	2,2	20	35	11,5	M4

Material 1.4401 | Not suitable for strands

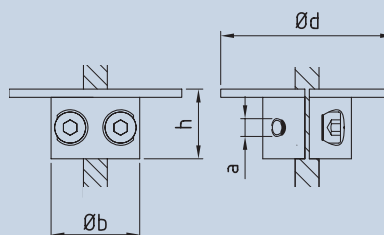

Light clamp ring

Part number	ørope	F ax	a	b	ø d1
863-0200	2	1	M3	10	15
863-0300	3	1,3	M3	10	15
863-0400	4	1,5	M3	10	15
863-0500	5	2	M4	10	20
863-0600	6	2,2	M4	10	20
863-0800	8	2,2	M4	10	20

Material 1.4401 | Not suitable for strands

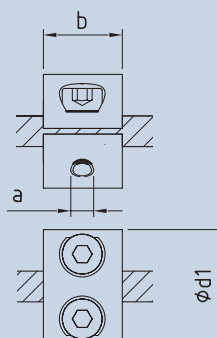

Loops, Clamps | Assembly

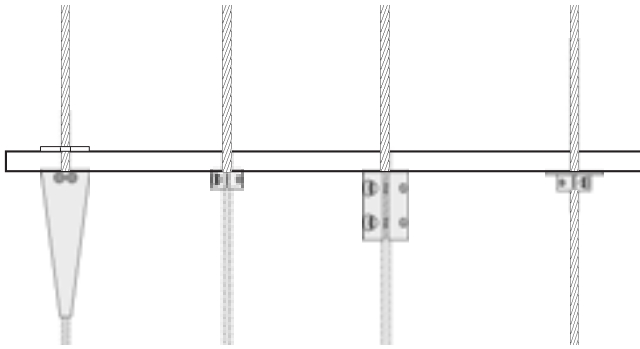

Loop clamps attached to bow shackle.

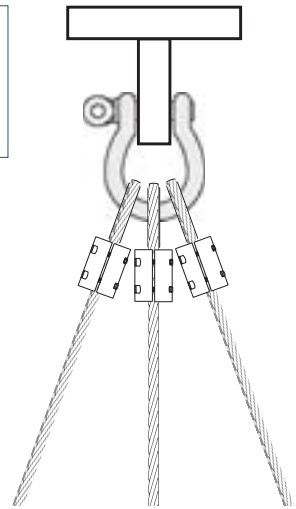

Cable cone clamp with cover disc, light clamp ring, clamp ring, light clamp ring with support for horizontal hanging of shelves and tablets.

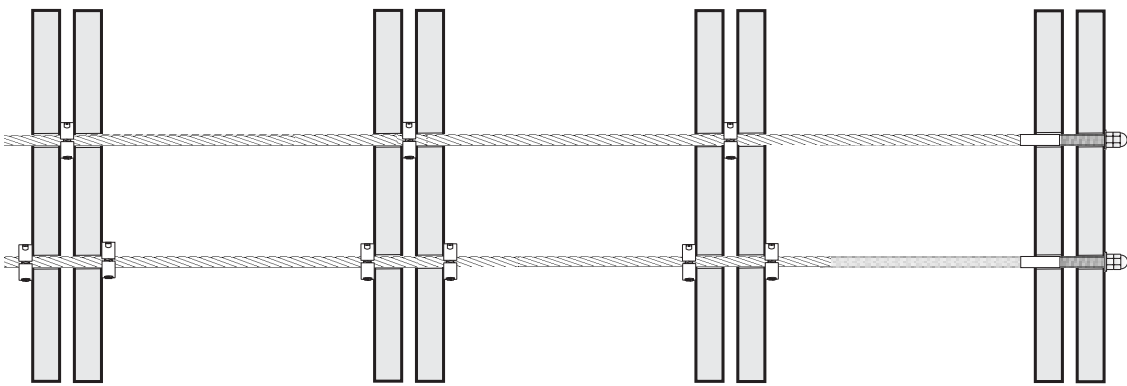

Light clamp rings for distribution of tensile forces over several profiles.

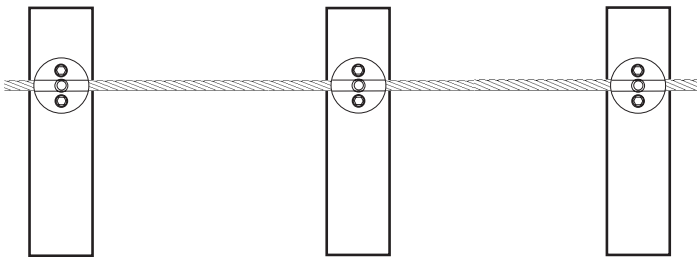

Two-part screw clamp for cable guide and clamping.

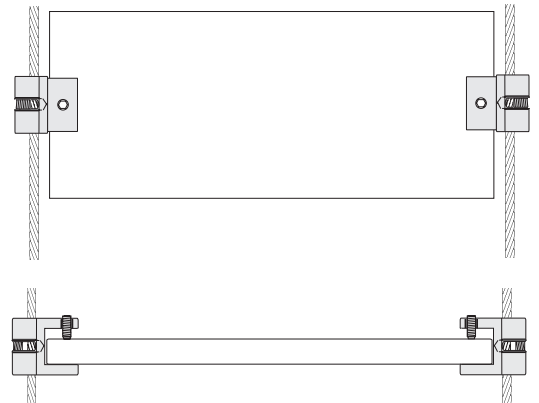

Double cable junction with clamping holder for horizontal and vertical hanging of displays and shelves.

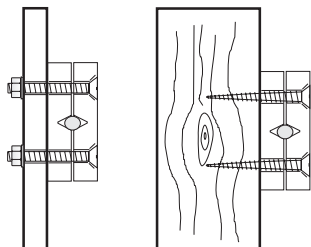

Two-part clamping plate for horizontal and vertical hanging of displays and shelves.



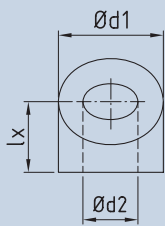

Angle stand off washer for external thread, flat profile

Part number	Thread	ø d1	ø d2
862-04-0	M4	10	4,3
862-05-0	M5	10	5,5
862-06-0	M6	13	7,3
862-08-0	M8	18	8,3
862-10-0	M10	22	10,5
862-12-0	M12	24	12,5
862-14-0	M14	24	14,5
862-16-0	M16	32	17
862-20-0	M20	32	21
862-24-0	M24	40	25

Material 1.4301

Please specify the required angle when ordering.

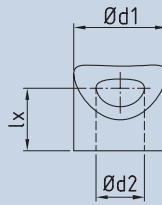

Angle stand off washer for external thread, round profile

Part number	Thread	ø d1	ø d2
862-04-1	M4	10	4,3
862-05-1	M5	10	5,5
862-06-1	M6	13	7,3
862-08-1	M8	18	8,3
862-10-1	M10	22	10,5
862-12-1	M12	24	12,5
862-14-1	M14	24	14,5
862-16-1	M16	32	17
862-20-1	M20	32	21
862-24-1	M24	40	25

Material 1.4301

Please specify diameter of post and angle when ordering.

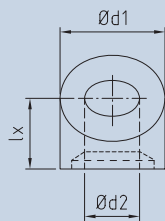

Angle washer for countersunk end stop 90°, flat profile

Part number	ø rope	ø d1	ø d2
862-03-2	3	13	7,3
862-04-2	4	13	8,3
862-05-2	5	18	8,3
862-06-2	6	18	10,5
862-08-2	8	24	13,5

Material 1.4301

Please specify the required angle when ordering.

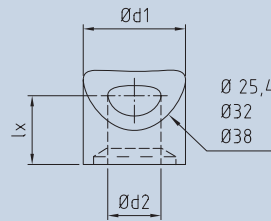

Angle washer for countersunk end stop 90°, round profile

Part number	ø rope	ø d1	ø d2
862-03-3	3	13	7,3
862-04-3	4	13	8,3
862-05-3	5	18	8,3
862-06-3	6	18	10,5
862-08-3	8	24	13,5

Material 1.4301

Please specify diameter of post and angle when ordering.

Length Lx for angled stand off washers

Angle	ø d1 (8 mm)	ø d1 (10 mm)	ø d1 (13 mm)	ø d1 (18 mm)	ø d1 (22 mm)	ø d1 (24 mm)	ø d1 (32 mm)	ø d1 (35 mm)	ø d1 (40 mm)
0° - 34°	5,3	5,9	6,8	8,2	9,4	9,9	12,2	13,1	14,5
35° - 40°	5,8	6,5	7,8	9,3	10,7	11,4	14,2	15,3	17
40° - 60°	6,4	7,2	8,5	10,6	12,2	13,1	16,4	17,7	19,8

For round post profiles specify the angle as well as the outside diameter of the post.

Standard washers with profiled forms to suit 1", 1 1/4" und 1 1/2" posts available.

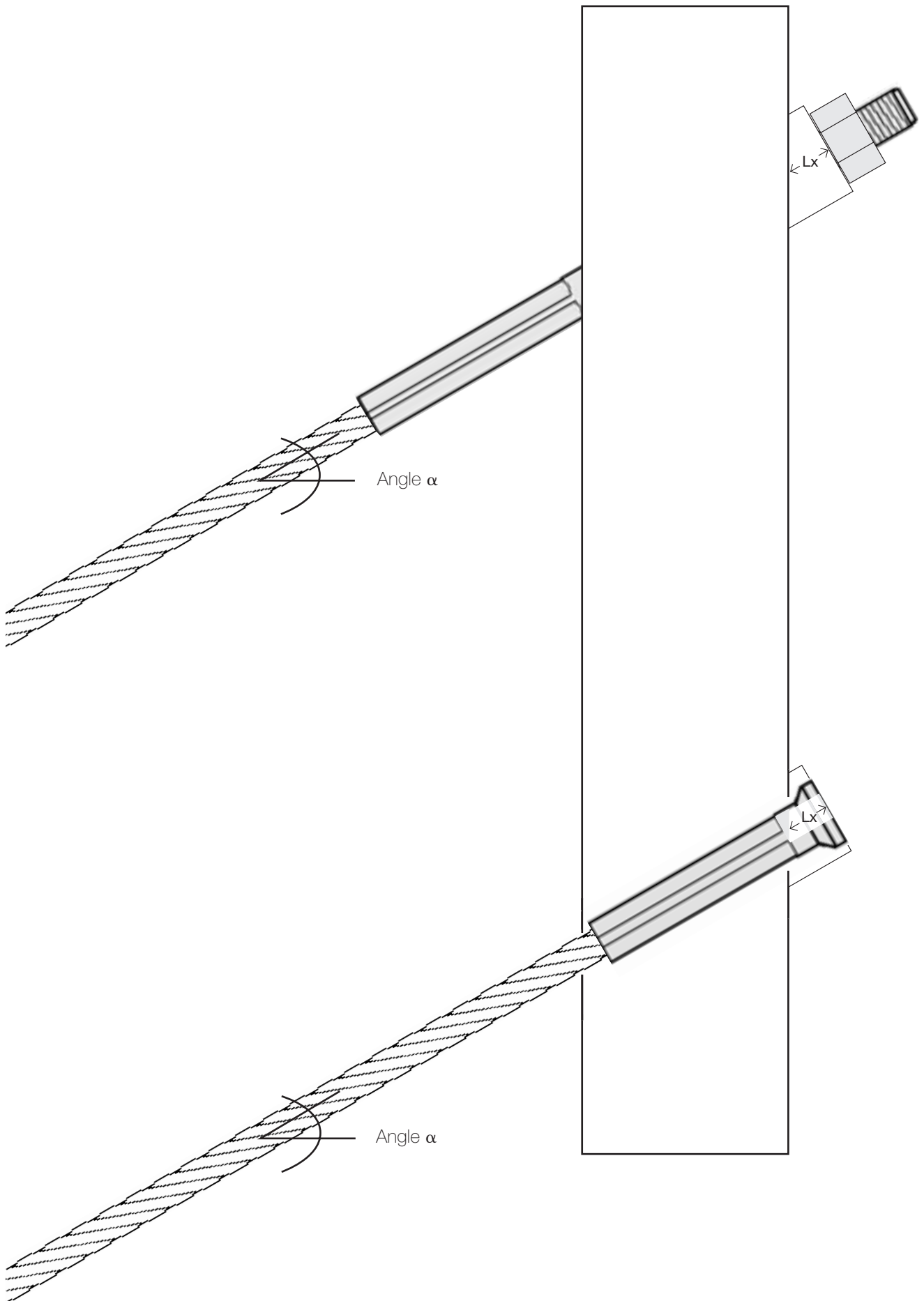

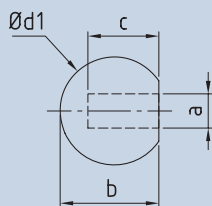

Ball end with internal thread

Part number RH thread	Part number LH thread	a	b	c	Ød1
898-0400-01	898-0400-02	M4	15	9	16
898-0500-01	898-0500-02	M5	15	9	16
898-0600-01	898-0600-02	M6	18,8	10	20
898-0800-01	898-0800-02	M8	22,4	12	24
898-1000-01	898-1000-02	M10	21,4	12	24

Material 1.4401

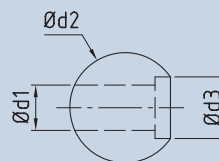
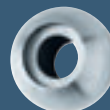

**Ball for internal thread
radius head**

Part number	Ød1	Ød2	Ød3
899-06	6,5	20	10
899-07	7,5	20	12
899-08	9	25	14
899-10	11	25	16

Material 1.4401

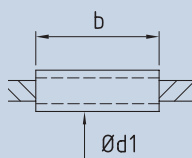

Loose sleeve

Part number	Ørope	Ød	b
864-0205	2	5	30
864-0206	2	6	30
864-0306	3	6	30
864-0307	3	7	30
864-0310	3	10	30
864-0407	4	7	30
864-0407 M	4	7	40
864-0407 L	4	7	55
864-0408	4	8	30
864-0408 M	4	8	40
864-0408 L	4	8	55
864-0410	4	10	30
864-0508	5	8	30
864-0508 M	5	8	40
864-0508 L	5	8	55
864-0513	5	13	30
864-0610	6	10	30
864-0610 M	6	10	40
864-0610 L	6	10	55
864-0613	6	13	30
864-0813	8	13	30
864-1018	10	18	50
864-1020	10	20	50
864-1222	12	22	50
864-1225	12	25	50
864-1424	14	24	50
864-1627	16	27	50
864-1632	16	32	50

Material 1.4404 | The sleeve can slide along the length of the cable. Secure the sleeve to the post profile not the rope.

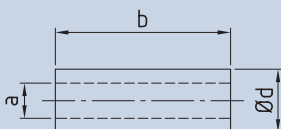

Thread sleeve

Part number	a	b	Ød
876-0625	M6	25	10
876-0830	M8	30	11
876-1030	M10	30	13
876-1230	M12	30	15
876-1640	M16	40	25

Material 1.4401

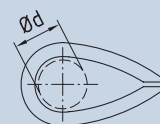

Thimble

Part number	Ørope	d1
5970.00.02	2	6,5
5970.00.03	3	9,5
5970.00.04	4	10,5
5970.00.05	5	12,5
5970.00.06	6	15,5
5970.00.08	8	17,5
5970.00.10	10	23,5
5970.00.12	12	25,5
5970.00.14	14	33,5
5970.00.16	16	36,5

Material 1.4401



Shackle

Part number	kN	b1	b2	Ød1	Ød2	Ød3
835-0032	10,79	10	20	5	5	10
835-0039	15,01	12	24	6	6	12
835-0050	28,45	16	32	8	8	16
835-0090	44,15	20	40	10	10	20
835-0120	59,84	24	48	12	12	24
835-0140	88,29	26	45	13	13	26
835-0200	112,82	32	64	16	16	32
835-0340	152,06	38	76	19	19	38

Material 1.4401

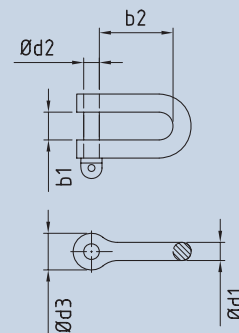

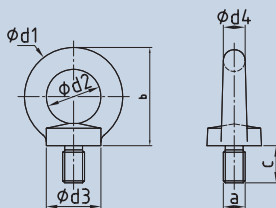

Eye bolt

Part number	kN	a	b	c	$\phi d1$	$\phi d2$	$\phi d3$	$\phi d4$
837-0600	4,2	M6	36	13	36	20	20	8
837-0800	8,4	M8	36	13	36	20	20	8
837-1000	13,8	M10	45	17	45	25	25	10
837-1200	19,8	M12	53	21	54	30	30	12
837-1600	41,4	M16	62	27	63	35	35	14
837-2000	70,8	M20	71	30	72	40	40	16
837-2400	106	M24	90	36	90	50	50	20

Material 1.4401 | DIN 580

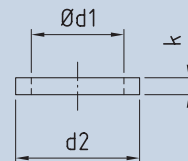

Flat washer

Part number	$\phi d1$	$\phi d2$	k
896-0400	M4	8	0,5
896-0500	M5	9	1
896-0600	M6	11	1,6
896-0800	M8	15	1,6
896-1000	M10	18	1,6
896-1200	M12	20	2
896-1600	M16	28	2,5
896-2000	M20	34	3
896-2200	M22	39	3
896-2400	M24	44	4
896-3000	M30	56	4

Material 1.4301

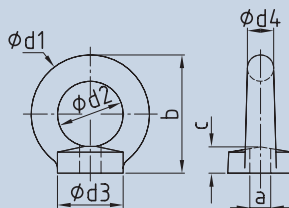

Eye nut

Part number	kN	a	b	c	$\phi d1$	$\phi d2$	$\phi d3$	$\phi d4$
838-0600	4,2	M6	36	8	36	20	20	8
838-0800	8,4	M8	36	8	36	20	20	8
838-1000	13,8	M10	45	10	45	25	25	10
838-1200	19,8	M12	53	11	54	30	30	12
838-1600	41,4	M16	62	13	63	35	35	14
838-2000	70,8	M20	71	15	72	40	40	16
838-2400	106	M24	90	20	90	50	50	20

Material 1.4401 | DIN 582

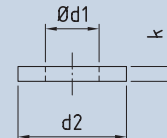

Washer for wood

Part number	$\phi d1$	$\phi d2$	k
896-0400-12	M4	12	1
896-0500-15	M5	15	1,2
896-0600-18	M6	18	1,6
896-0800-24	M8	24	2
896-1000-30	M10	30	2,5
896-1200-37	M12	37	3
896-1600-50	M16	50	3
896-2000-60	M20	60	4

Material 1.4301

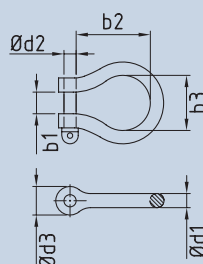

Bow shackle

Part number	kN	b1	b2	b3	$\phi d1$	$\phi d2$	$\phi d3$
835-0016-01	5,89	8	18	14	4	4	8
835-0024-01	10,20	10	23	17	5	5	10
835-0036-01	14,13	12	26	21	6	6	12
835-0056-01	27,47	16	36	28	8	8	16
835-0086-01	42,38	20	46	34	10	10	20
835-0130-01	56,51	24	54	42	12	12	24

Material 1.4401

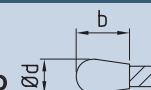

Wire rope end cap

Part number	ϕ_{rope}	b	ϕd
904-0200	2	10,2	6,3
904-0300	3	8,8	5,5
904-0400	4	8,8	5,5
904-0500	5	8	7,5
904-0600	6	12	7,5
904-0800	8	13	11,5
904-1000	10	14,6	13,4

Black plastic

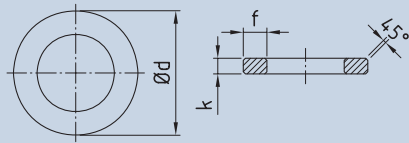

Connection ring

Part number	k	f	Ø d	kN of rope*
IRS1	5	6	70	0,41
IRS2	6	7,5	70	0,79
IRS3	8	9	100	1,11
IRS4	8	11	110	1,43
IRS5	10	13	120	2,34

Material 1.4571

*maximum tension force (in 4 directions)

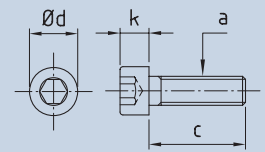

Socket head screw

Part number	a	c	Ø d	k
844-0400	M4	25	7	4
844-0500	M5	25	8,5	5
844-0600	M6	30	10	6
844-0800	M8	35	13	8
844-1000	M10	40	16	10
844-1200	M12	50	18	12
844-1600	M16	60	24	16
844-2000	M20	70	30	20

Material 1.4301

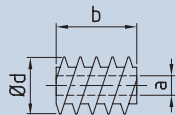

Rampa screw for wood

Part number	a	b	Ø d	Ø x
803-0400-04	M4	12	8	6,9
803-0500-04	M5	14	10	8,9
803-0600-04	M6	15	12	10,4
803-0601-04	M6	25	12	10,4
803-0800-04	M8	18	16	14,5
803-0801-04	M8	30	16	14,5
803-1000-04	M10	25	18,5	16,7
803-1001-04	M10	40	18,5	16,7

Blue galvanised steel | Type SK hexagon socket (~DIN 7965)
Ø x = Pilot hole in wood

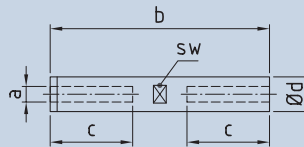

Cylindrical turnbuckle barrel LH/RH

Part number	a	b	c	Ø d	sw
875-0500-01	M5	60	25	8	7
875-0500-02	M5	100	45	8	7
875-0600-01	M6	70	30	10	9
875-0600-02	M6	120	55	10	9
875-0800-01	M8	70	30	12	11
875-0800-02	M8	120	55	12	11

Material 1.4401

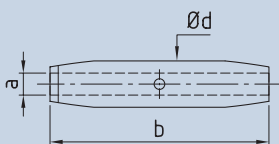

Turnbuckle barrel with internal thread LH/RH

Part number	a	b	Ø d
875-0500	M5	80	8
875-0600	M6	92	10
875-0800	M8	112	13,5
875-1000	M10	120	17,2
875-1200	M12	150	21,3
875-1400	M14	170	21,3
875-1600	M16	190	26,9
875-2000	M20	220	33,7
875-2400	M24	328	50

Material 1.4401

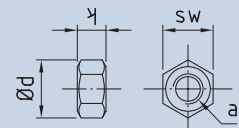

Hexagon nut

Part number RH thread	Part number LH thread	a	d	k	sw
892-0400	893-0400	M4	7,7	3,2	7
892-0500	893-0500	M5	8,8	4	8
892-0600	893-0600	M6	11,1	5	10
892-0800	893-0800	M8	14,4	6,5	13
892-1000	893-1000	M10	18,9	8	17
892-1200	893-1200	M12	21,1	10	19
892-1400	893-1400	M14	24,5	11	22
892-1600	893-1600	M16	26,8	13	24
892-2000	893-2000	M20	33,5	16	30
892-2200	893-2200	M22	35	18	32
892-2400	893-2400	M24	39,5	19	36
892-3000		M30	50,8	24	46

Material 1.4301

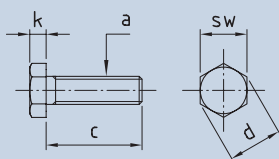

Hexagon head screw

Part number	a	c	d	k	sw
843-0400	M4	25	7,7	2,8	7
843-0500	M5	30	8,8	3,5	8
843-0600	M6	30	11,1	4	10
843-0800	M8	40	14,4	5,3	13
843-1000	M10	50	18,9	6,4	17
843-1200	M12	70	21,1	7,5	19
843-1400	M14	70	24,5	8,8	22
843-1600	M16	90	26,8	10	24
843-2000	M20	100	33,5	12,5	30

Material 1.4301

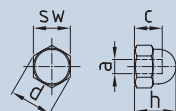

Dome nut RH

Part number	a	c	h	d	sw
894-0400	M4	4,1	8	7,7	7
894-0500	M5	5,9	10	8,8	8
894-0600	M6	6	12	11,1	10
894-0800	M8	8,5	15	14,4	13
894-1000	M10	10	18	18,9	17
894-1200	M12	11,7	22	21,1	19
894-1400	M14	13	25	24,5	22
894-1600	M16	16	28	26,8	24
894-2000	M20	19,7	34	33,5	30

Material 1.4301

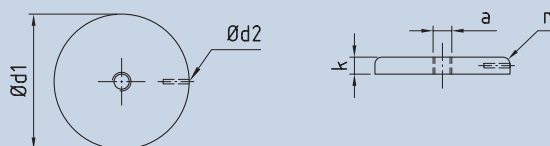

Cover disk with internal thread

Part number	Part number	a	Ød1	Ød2	r	k
RH thread	LH thread					
836-0500-05	836-0500-06	M5	35	1,5	2,5	4
836-0600-05	836-0600-06	M6	35	1,5	2,5	4
836-0800-05	836-0800-06	M8	50	3,5	3	6
836-1000-05	836-1000-06	M10	50	3,5	3	6

Material 1.4404

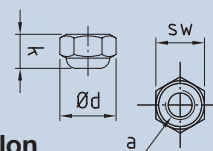

Lock nut with nylon insert RH

Part number	a	d	k	sw
892-0400-02	M4	7,7	5	7
892-0500-02	M5	8,8	5	8
892-0600-02	M6	11,1	6	10
892-0800-02	M8	14,4	8	13
892-1000-02	M10	18,9	10	17
892-1200-02	M12	21,1	12	19
892-1400-02	M14	24,5	14	22
892-1600-02	M16	26,8	16	24
892-2000-02	M20	33	20	30

Material 1.4301

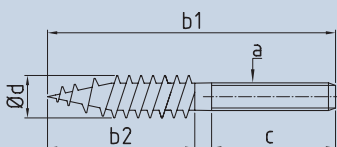

Dual thread screw

Part number	Part number	a	b1	b2	c	Ød
RH thread	LH thread					
878-0500	877-0500	M5	50	30	20	4,3
878-0600	877-0600	M6	70	40	30	5,2
878-0800	877-0800	M8	100	60	40	6,9

Material 1.4301 | Ød = for wall plug

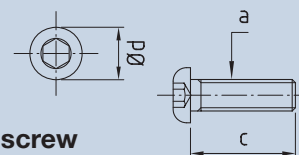

Pan head screw

Part number	a	c	Ød
890-0400-025	M4	25	7,5
890-0500-020	M5	20	9,5
890-0500-025	M5	25	9,5
890-0500-030	M5	30	9,5
890-0600-020	M6	20	10,5
890-0600-025	M6	25	10,5
890-0600-030	M6	30	10,5
890-0800-030	M8	30	14
890-0800-040	M8	40	14

Material 1.4301

Accessories



Threaded rod

Part number RH thread	Part number LH thread	a	c
882-0500-060	883-0500-060	M5	60
882-0500-100	883-0500-100	M5	100
882-0600-060	883-0600-060	M6	60
882-0600-100	883-0600-100	M6	100
882-0800-060	883-0800-060	M8	60
882-0800-120	883-0800-120	M8	120
882-0800-220	883-0800-220	M8	220
882-1000-060	883-1000-060	M10	60
882-1200-080	883-1200-080	M12	80
882-1600-080	883-1600-080	M16	80

Material 1.4305

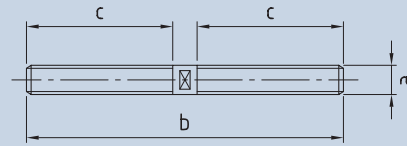
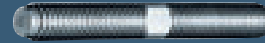

Headless screw RH/LH

Part number	a	b	c
884-0400	M4	45	20
884-0500	M5	65	30
884-0600	M6	65	30
884-0800	M8	65	30
884-1000	M10	85	40
884-1200	M12	105	50
884-1400	M14	105	50
884-1600	M16	125	60
884-2000	M20	125	60

Material 1.4305

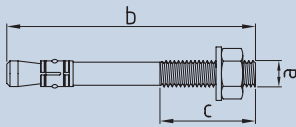

Wall Anchor B A4

Part number	a	b	c
803-0600-08	M6	67	20
803-0800-08	M8	75	25
803-1000-08	M10	80	30
803-1200-08	M12	180	80

Material 1.4401 | Assembly instructions on request

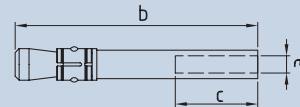

Wall Anchor Z-IG A4

Part number	a	b	c
803-0600-07	M6	50	20
803-0800-07	M8	62	22
803-1000-07	M10	70	23
803-1200-07	M12	86	27

Material 1.4401

Assembly instructions on request



Plastic wall plug for dual thread screw

Part number	b x d	$\varnothing S$
803-0700-03	6 x 36	4,3 - 5
803-0800-03	8 x 51	5 - 6
803-1000-03	10 x 61	6 - 8

b x d = \varnothing Drill hole x Plug length | S = Dual thread screw
Assembly instructions on request



Wire rope cutter

Part number	up to \varnothing rope	Length
740-0500	5	190
740-0800	8	500



Thread lock fluid

Part number 879-0001

Thread fixing material: lacquer-type coating of two micro encapsulated components of a modified acrylate system. The characteristic as locking and sealing elements are active when the coated threaded part is screwed in and tensioned. In this process, the microcapsules are destroyed, their contents are mixed together and harden completely within an extremely short time. The connection is completely sealed and vibration-proof. This ensures that the tension is maintained and the fastener cannot become loose of its own accord. The locking of the thread is an integral part of the fastener.



Special adhesive for metal

Part number 879-0003

Special adhesive for metal: For fixing of high-strength cylindrical parts e.g. movable cable sleeves
 Temperature range -50°C to +50°C
 final fixing after 12 hours.



Injection mortar VM

Part number	contents
803-150	150 ml
803-345	345 ml

Injection mortar: on vinyl ester base | styrene free
 Assembly instructions on request



Insertion tool for wall anchor Z-IG A4

Part number	for thread
803-0600-09	M6
803-0800-09	M8
803-1000-09	M10
803-1200-09	M12



Perforated sleeve VM-SH for hollow stones

Part number	for thread
803-68	M6-M8
803-812	M8-M12

Plastic
 Assembly instructions on request



Centrebore drill with receptor

Part number 912-11

In combination with hole saw 912-64



Hole saw

Part number 912-64

Application: preparation for rigid mounted block in soft faced walls for support pipe part number 897-060







The I-SYS greenery system is clearly designed, simple to plan, easy to mount and can be adapted to different facades and plants. Its high-quality elements add to the architecture of many structures even without plants, and later re-tains the green covering in position for years. Harmonised components form the basis and therefore make design and construction simpler. There are two types of end and intermediate holders as well as cables are available for normal and particularly high tensile loads.



I-SYS: Greenery

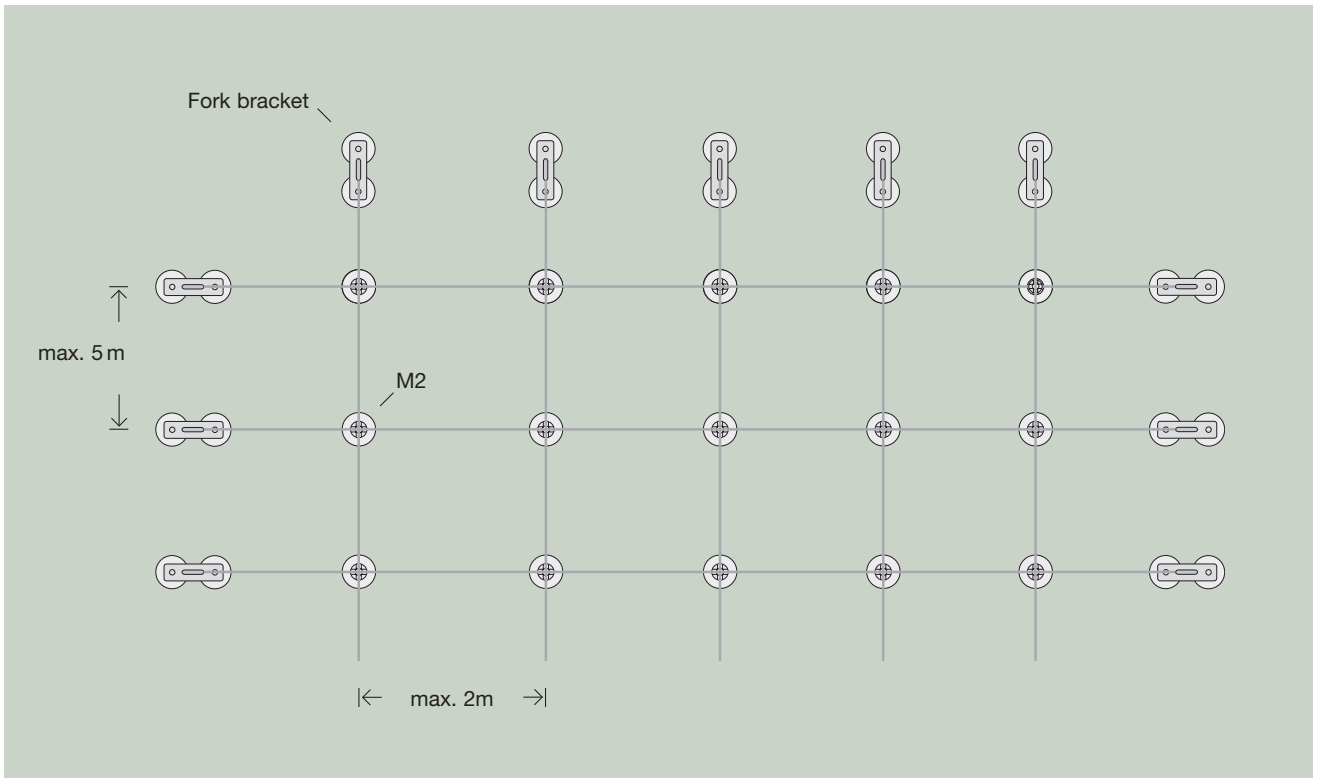

Greening systems must take up high forces. These are dispersed via end holders in the masonry. The fork bracket was developed for particularly high load forces. Its low leverage force and double anchorage take up pressure and tensile forces safely.



Wall holder set K2

Contents:

- Cable assembly IK330-0400
- 1 x Small fork bracket 834-006
- 2 x Cover disk 836-0800-80
- 2 x Supporting tube of plastic or support tube of stainless steel, adjustable
- 2 x Sealing ring for support tube 897-8
- 2 x Fixing elements according to mounting base material

Support tubes and sealing rings are not needed for facades without heat insulation.



Wall holder set M2

Contents:

- 1 x Baseplate 836-0800-70
- 1 x Cross clamp 919-061, -101, -141
- Fixing elements such as threaded bolt, stop screws, support tubes, plugs according to the mounting base material



Wall holder set M1

Contents:

- 1 x Baseplate 836-0800-70
- 1 x Distance sleeve 919-080, -120, -160
- 1 x Attachment screw 923-0800-17
- Fixing elements such as threaded bolt, stop screws, support tubes, plugs according to the mounting base material

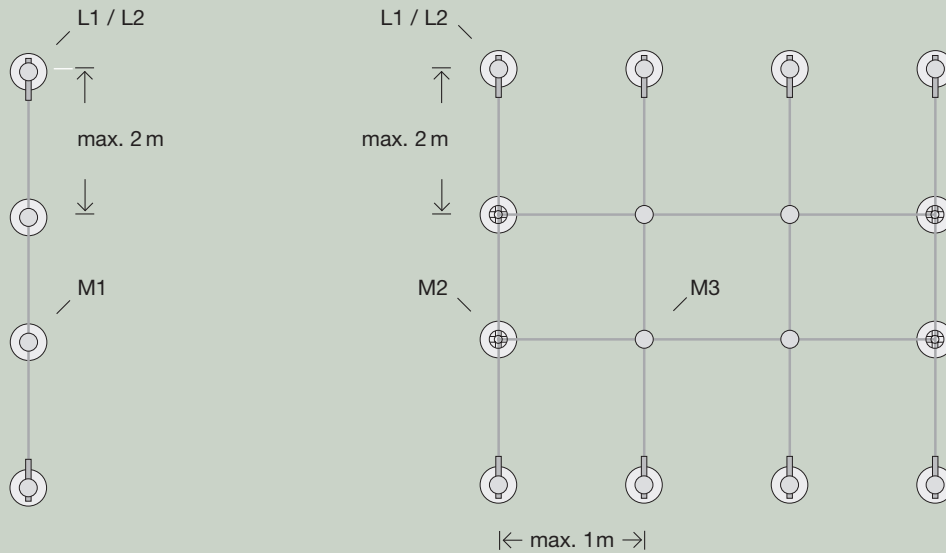

Attractive wall holders allow creative solutions. Individual forms are created from the combination of selected individual elements from the greening system. The design follows the architecture, leaves windows, doors or bays open or develops its own forms as a decorative element for the facade.



Cross clamp M3

90° CS cable junction of stainless steel

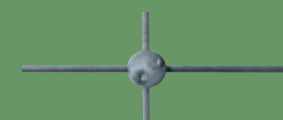

Cross clamp M3

90° CS cable junction of plastic

Wall holder set L1

Contents:

Cable assembly IK100-0400

Radius head end stop with internal thread 869-0600-02

1 x Baseplate 836-0800-70

1 x Distance sleeve 919-080,-120,-160

1 x Attachment screw 923-0800-10

Fixing elements such as threaded bolt, stop screws, support tubes, plugs according to the mounting base material

Wall holder set L2



Contents:

Cable assembly IK140-0400

Radius head end stop with internal thread 869-0600-02

1 x Baseplate 836-0800-70

1 x Distance sleeve 919-080,-120,-160

1 x Attachment screw 923-0800-10

Fixing elements such as threaded bolt, stop screws, support tubes, plugs according to the mounting base material

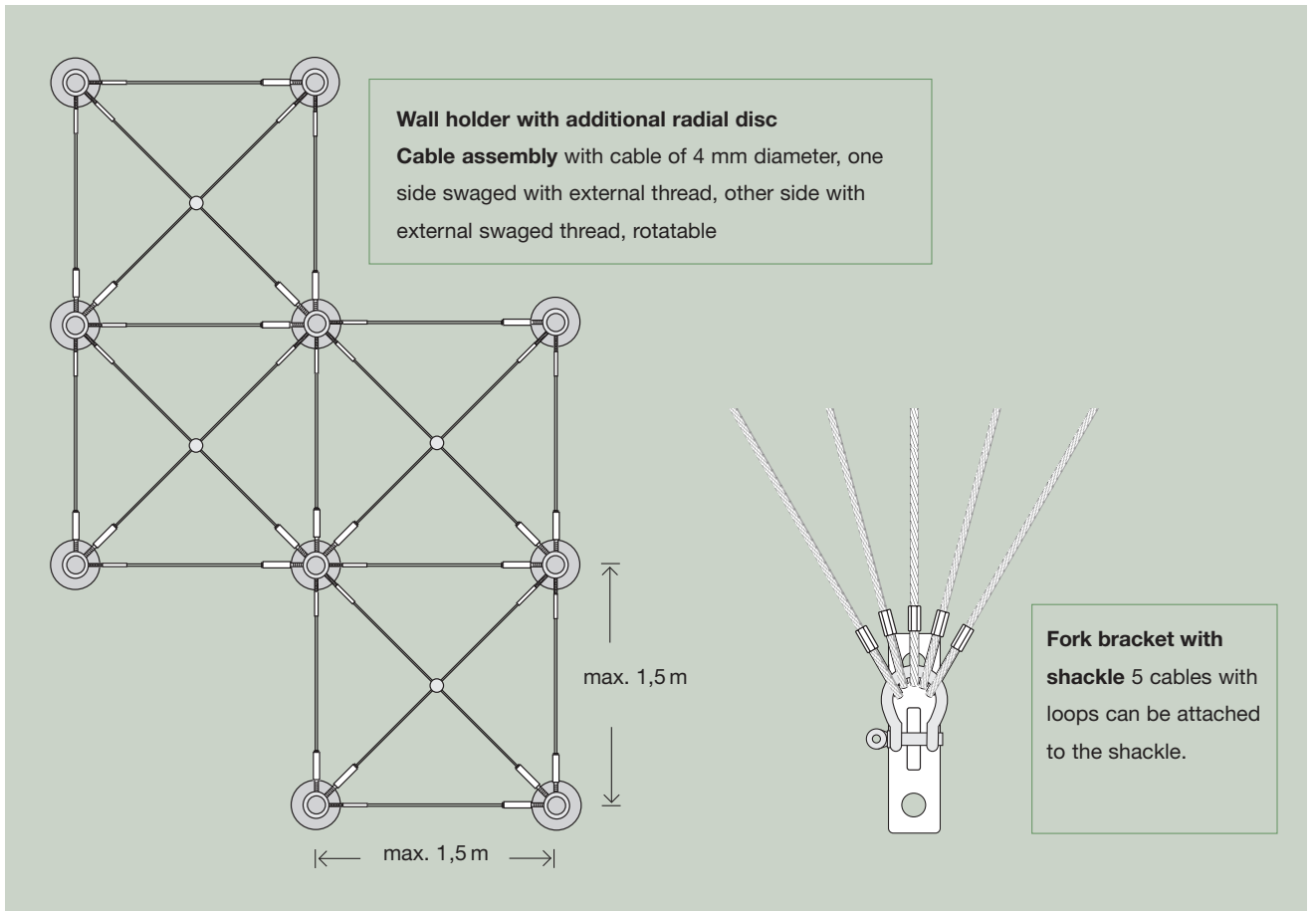



Fork bracket

Part number	h	c	b	ø d	e	g	k
834-006	150	120	30	12	8	6	40
834-012	262	210	53	14	14	12	70

Material 1.4404

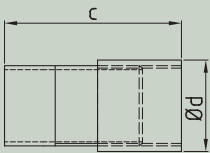
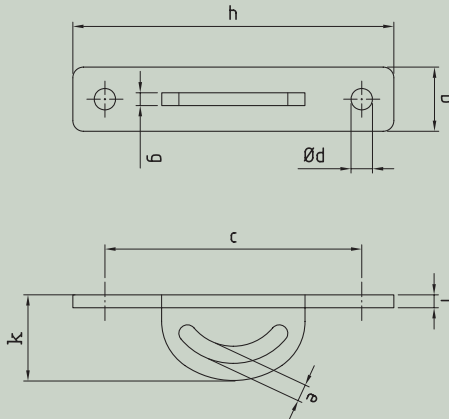

Stainless steel support tube adjustable

Part number	c	ø d	adj. path
897-103	103	54,5	+14 -22
897-138	138	54,5	+14 -22
897-173	173	54,5	+14 -22

Material 1.4404

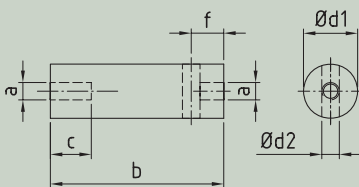
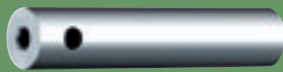

Spacer bar

Part number	a	b	c	ø d1	ø d2	f
919-080	M8	80	20	25	8,1	15
919-120	M8	120	20	25	8,1	15
919-160	M8	160	20	25	8,1	15

Material 1.4404

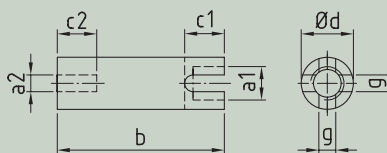

Cross clamp spacer bar

Part number	a1	a2	b	c1	c2	ø d	g
919-061	M12	M8	83	22	20	25	6,5
919-101	M12	M8	123	22	20	25	6,5
919-141	M12	M8	163	22	20	25	6,5

Material 1.4404

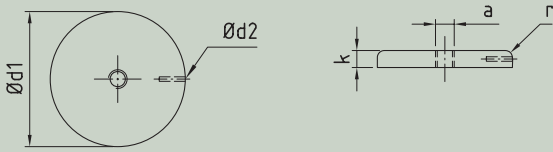

Cover disk with internal thread

Part number

RH thread	a	$\varnothing d1$	$\varnothing d2$	r	k
836-0800-80	M8	80	3,5	3	6

Material 1.4404

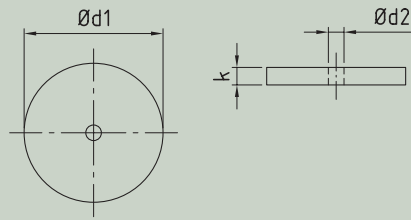

Ground plate

Part number

$\varnothing d1$	$\varnothing d2$	k	
836-0800-70	70	8,1	6

Material 1.4571

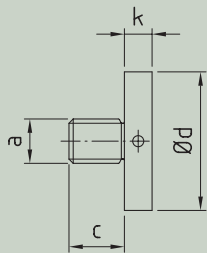

Clamp screw

Part number

a	c	$\varnothing d$	k	
923-0800-10	M8	10	25	5
923-0800-17	M8	17	25	5
923-0800-22	M8	22	25	5
923-1200-10	M12	10	25	5
923-1200-15	M12	15	25	5

Material 1.4404

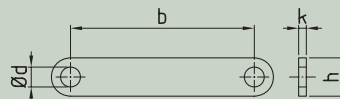

Support link

Part number

b	$\varnothing d$	h	k	
834-120	120	13	25	5

Material 1.4401

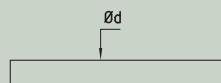

Stainless steel rod

Part number

$\varnothing d$	
922-0400	4
922-0800	8

Material 1.4571, Rod length max. 2 m

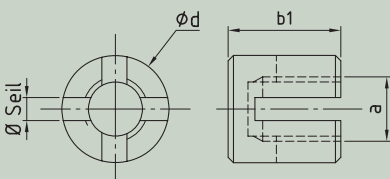

Cross clamp 90°

Part number

$\varnothing rope$	a	b1	$\varnothing d$	
858-0400	4	M12	21	20

Material 1.4401

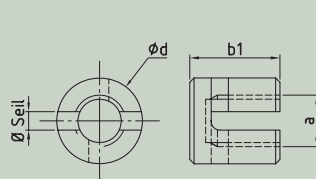

Cross clamp adjustable

Part number

$\varnothing rope$	a	b1	b2	$\varnothing d$	
858-0400-01	4	M12	19,5	3,5	20

Material 1.4401

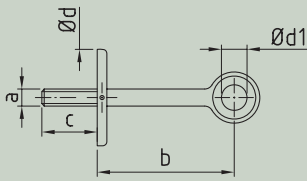

Eyebolt with support washer

Part number	c	b1	b2	Ød	d1	a
836-0086	24	110	86	50	8,1	M8

Material 1.4401 | maximum lateral load 0,3 kN

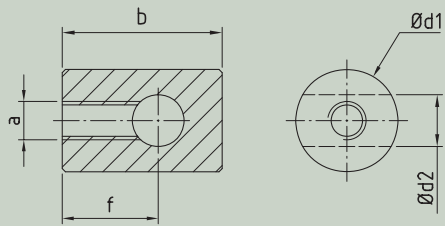

Rod/Rope holder

Part number	a	b	Ød1	Ød2	f
921-0600-12	M6	25	16	8,1	15

Material 1.4404

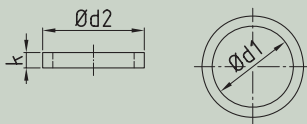

Sealing ring for pipe support

Part number	Ød1	Ød2	k
897-8	60	72	8

Material cell rubber

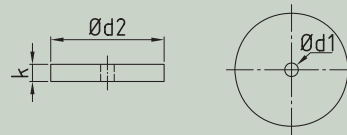

Sealing disk for support tube

Part number	Ød1	Ød2	k
897-9	10	80	5

Material EPDM

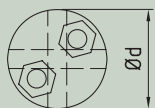

CS-Cross clamp 90° plastic, grey

Part number	Ø rope	Ø d
920-0400	4	21

UV-resistant

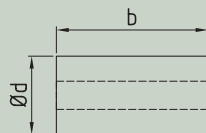

Pipe support

Part number	b	Ø d
897-060	variabel	60

Material polypropylene

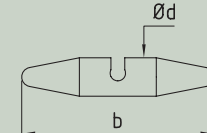

Climber stud plastic, grey

Part number	Ø rope	b	h
924-0400	4	50	10

UV-resistente



Cross clamp adjustable with internal thread

Part number	Ørope	a1	a2	b1	Ød	c
858-0400-02	4	M12	M8	31	20	10

Material 1.4401

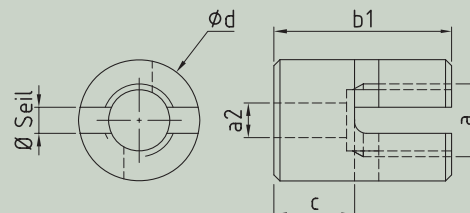

Technical information

The wall holders are fixed on a pressure-resistant foundation. Additional support tubes are used beneath the wall holders in heat-insulated facades. They transfer the forces directly into the masonry and therefore preserve the surface of the facade. The pitch is selected according to various different criteria. These include the type of plant and its inherent weight, the mounting base and the wall structure, the height and width of the greenery as well as the wind forces.

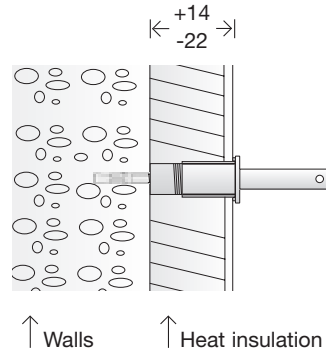
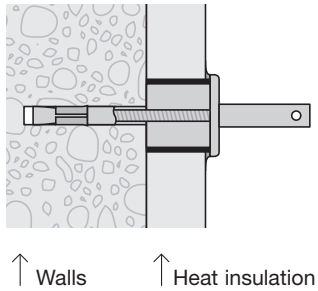

Example: mounting on heat-insulated facade

Support tube in heat-insulated area with core removing hole and cylinder saw

Support tube projects approx. 3 mm beyond the facade, sealing between facade and baseplate is by means of sealing ring or silicon bead

Wall anchor Z-IG M8

Threaded rod M8

Ground plate

Spacer bar

Example: mounting on heat-insulated facade

Stainless steel support tube adjustable in heat-insulated area with core removing hole and cylinder saw

Support tube projects approx. 3 mm beyond the facade, sealing between facade and baseplate is by means of sealing ring or silicon bead

Wall anchor Z-IG M8

Threaded rod M8

Ground plate

Spacer bar

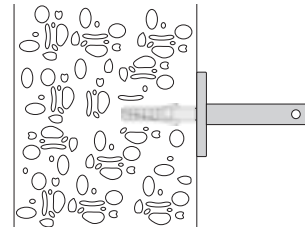
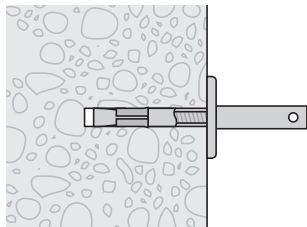

Example: mounting in concrete or natural stone

Wall anchor B M8

Ground plate

Spacer bar

Example: mounting in concrete or natural stone

Plastic wall plug

Dual thread screw M8

Ground plate

Spacer bar

Special Service

Carl Stahl provide a comprehensive service with planning, calculation and prompt deliveries.

Checklist for planning

The following information is needed for planning:

1. Type of plants to be used
2. Hand sketch with dimensions for the desired direction of the greenery
3. Sketch showing structure of facade

Examples:

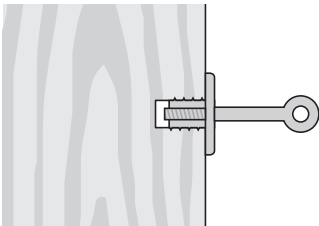
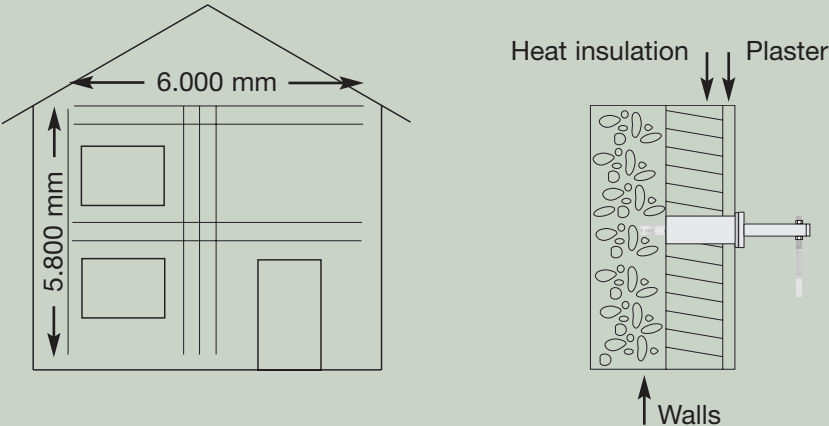

Example: mounting in wood

Screw-in bushing for wood
Screw eye with support plate

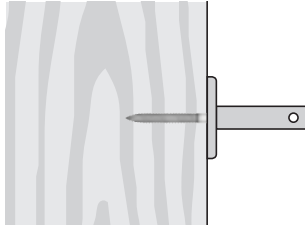

Example: mounting in wood

Dual thread screw M8
Ground plate
Spacer bar

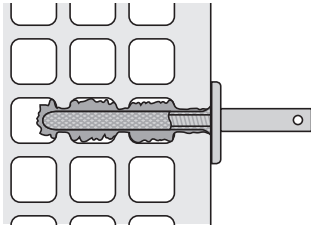

Example: mounting in cavity wall

Composite mortar with perforated sleeve
Threaded rod M8
Ground plate
Spacer bar

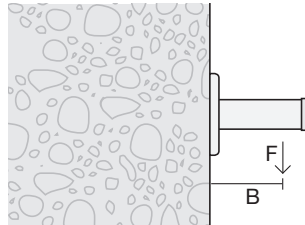

Maximum transverse forces of wall holders

max.Force F in kN	Facade to cable axis B in mm
2,5	71
1,5	111
1	151



Assembly

Ready-made stainless steel cable assemblies \varnothing 6 mm are guided through clamp-type carriers on the glass to a fixing plate on the wall. The glass pane exhibits a maximum width of 1,750 mm and maximum depth of 1,250mm. The downward angle of the pane can be selected between 0 and 15 degrees.

I-SYS: Canopy



The I-SYS canopy fits in with any type of house, traditional or modern, terraced or detached. The glass roof can be adapted to many forms because of its simple design. The minimal number of fittings, flexibility of the angle, even after assembly and mounting, as well as the fact that there are no holes in the glass means that the roof provides a fitting entrance to the house as well as being extremely cost effective.





I-SYS: Balustrade

The I-SYS programme for balustrade gives scope for individual forms for stairways, walkways and platforms. Specially developed for self-assembly and installation, the stainless steel cables of 4 mm diameter are supplied with fixable end connections. The cable assemblies automatically follow any angle. Posts and handrails with a diameter of 42.4 mm complete this well-designed and thought-out product range.



Special Service

Carl Stahl provide a comprehensive service with planning, calculation and prompt deliveries.



Fixing can either be on the face or the tread surface.

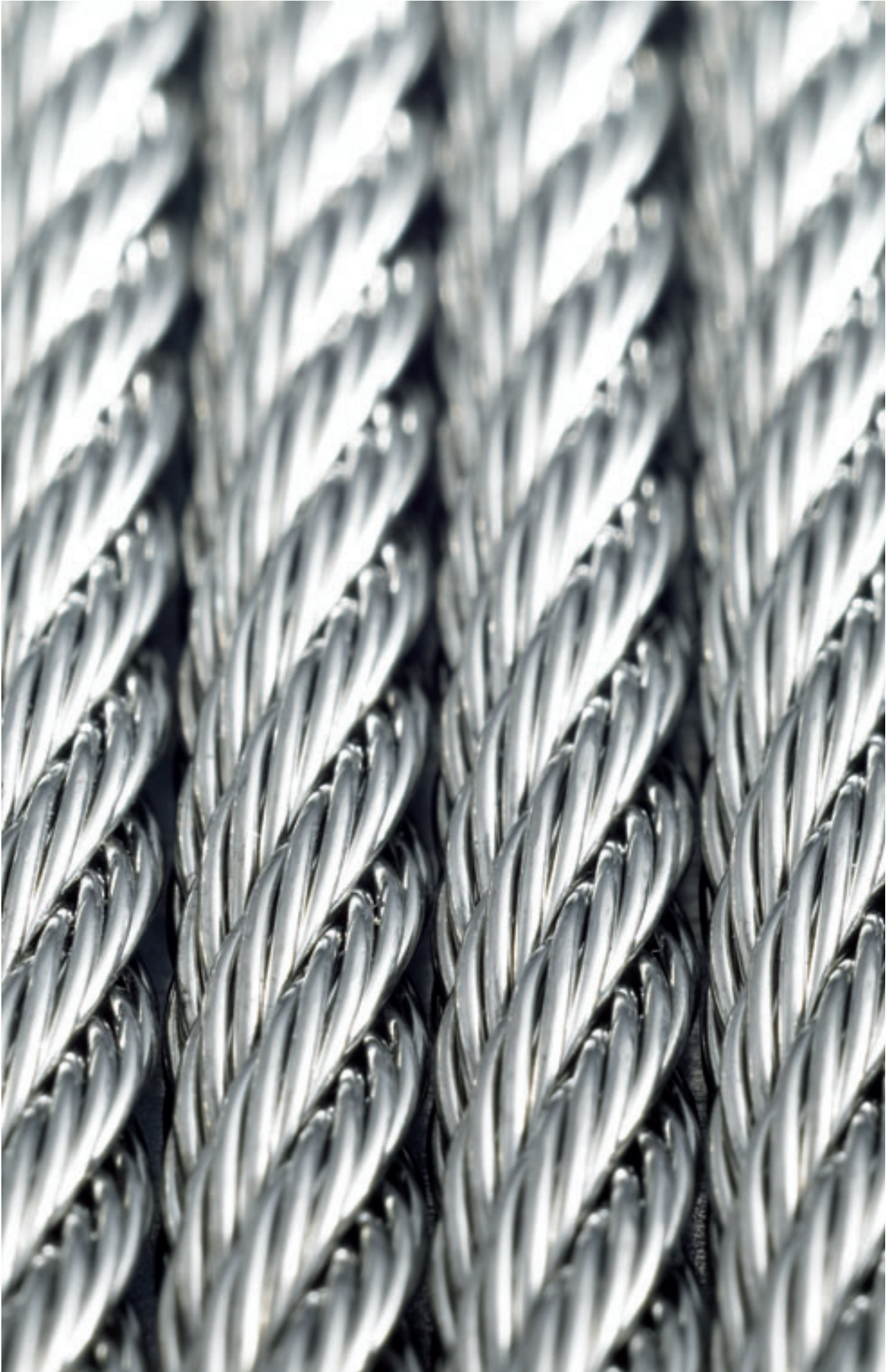

The German Institute for Building Technology in Berlin granted general planning approval for different types of I-SYS end connections with different types and diameters of stainless steel cables. This approval is like a quality seal of authorization which confirms the quality of I-SYS. Approved safety offers benefits for design and architectural implementation, as it considerably speeds up procedures and approvals on site. Further parts of the I-SYS programme are already being tested by the approval body and are subject to extremely strict controls.

Current information is available in the brochure entitled: Carl Stahl general planning approval.



I-SYS: Assured safety

I-SYS: Technology

Material

I-SYS cables and end connections are manufactured of stainless steel. This material is corrosion-resistant to marine standards. We will be pleased to supply you with more details on the material characteristics on request.

Forces

Cables sag because of the weight of the cable itself and additional external forces such as wind or the weight of snow. This affects fixing at end connections. Cable forces can be very high, depending on how much the sag is reduced, and they must be transferred into the fixing profile. If the forces are very high, it is also useful to distribute the cable forces which affect the starting and final fixing points among intermediate fixings.

Selection

Pretensioning forces plus external forces result in the effective cable force. To this is added a safety factor at the planner's discretion. The result of these calculations leads to selection of a cable or wire with corresponding minimum breaking load.

Securing

End connections have to be secured against the possibility that they may loosen by themselves. This is achieved by means of countered hexagonal or locking nuts or liquid thread locking materials.

Certification

Carl Stahl is certified to DIN ISO 9110:2000.



Strand 1 x 19 | 1 x 37 | 1 x 61

Characteristics Rigid, low stretch characteristics, high minimum breaking load

Use Structural applications, for example wind stiffening structures, general stiffening structures, suspension of canopies

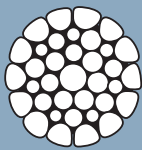

Compact Strand 1 x 19 | 1 x 36

Characteristics Very rigid, very low stretch characteristics, high tensile strength, high resistance to wilful damage and vandalism

Use Structural applications, for example wind stiffening structures, general stiffening structures, suspension of canopies

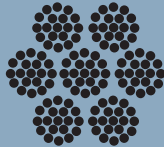

Rope 7 x 7 | 7 x 19

Characteristics Medium flexibility, can be angled and directionally reversed, for universal use

Use Use as architectural feature, for example stairway and walkway fillings, greenery, shelf hanging

E-Module: The elasticity module states the average values

round-wire cable $1.0 \times 10^5 \text{ N} / \text{mm}^2$

spiral cable $1.3 \times 10^5 \text{ N} / \text{mm}^2$

I-SYS: Dimensions

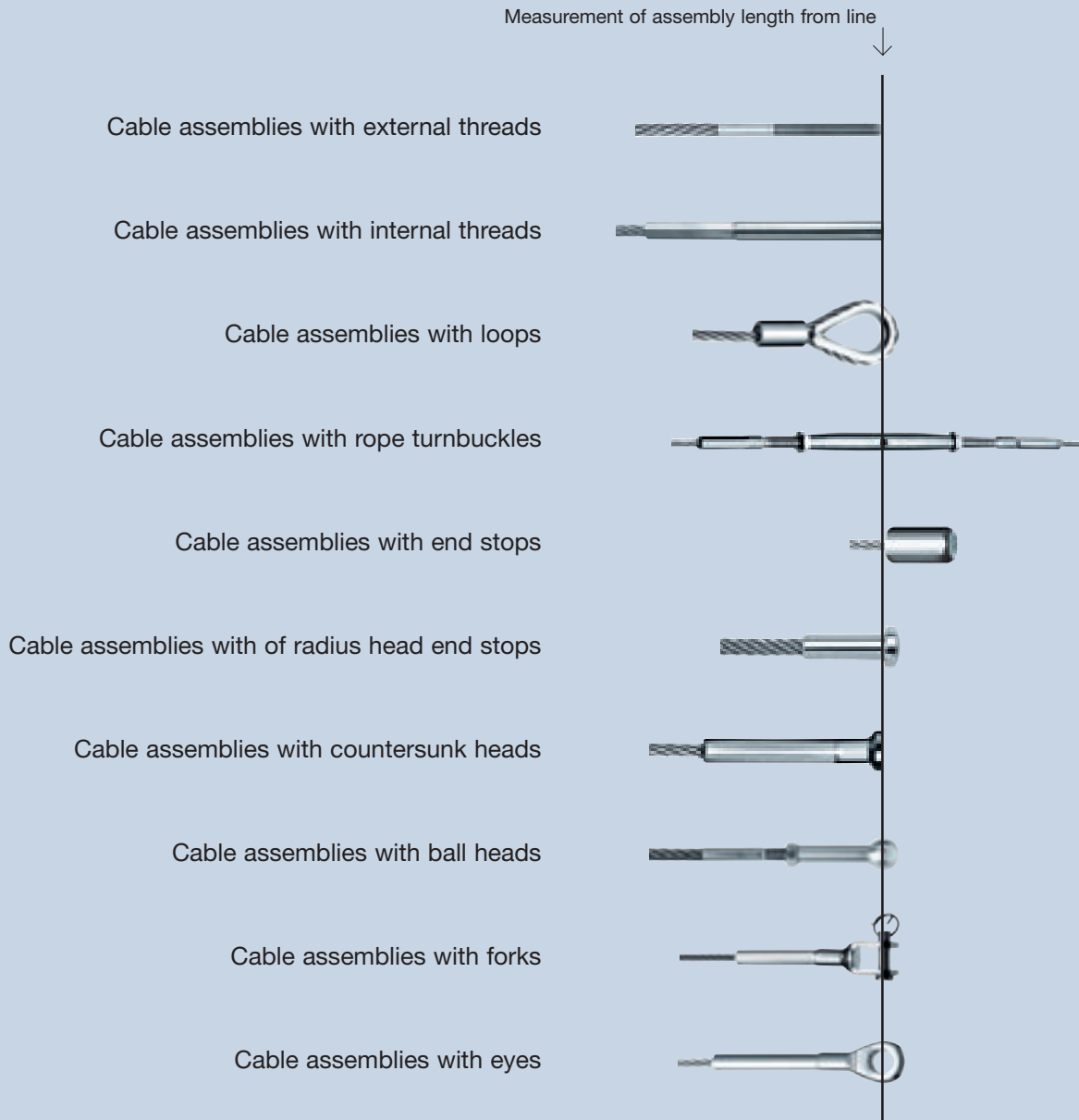

Examples

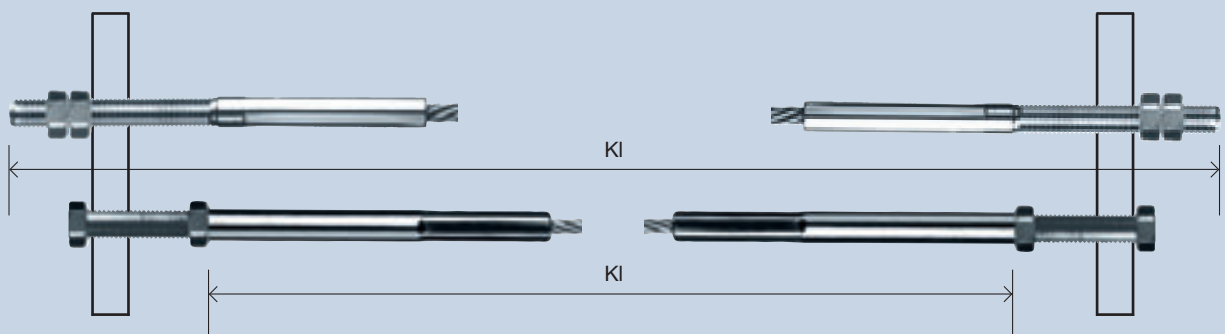

I-SYS: Key

All information regarding diameters, adjustments etc. are given in millimetres.

c		kN
Measurement of screw-in depth for internal threads in millimetres		Kilo Newton unit of measurement for minimum breaking loads in cables and end connections
Fax	Se	MQ
Maximum axial force in kN	End of cable	Metal cross-section of cables and wires in mm ² The metal cross-section is the sum of the nominal diameters of all the individual wires
Adjustment		
Starting point for adjustment: + means less tension - means more tension		Self-assembly Individual components and cables can be mounted on site For self-assembly the cables need to be degreased first
Sk	KI	
Rope constructions The cable assemblies are generally made from round wire cable	Assembly lengths Position for measuring	

Further information, general terms and conditions of business, tenders: www.carlstahl.com.

Carl Stahl: Product Range

X-TEND

The stainless steel mesh offers various possibilities for use in architecture and interior design. Different diameters and flexible mesh sizes allow tailor-made solutions, from safety structures, stairways, walkways and platforms through zoo enclosures and greeneries up to three-dimensional structures.

CABLE CONCEPT

Steel mesh furniture, from comfortable garden loungers to elegant office chairs. Our range of chairs, loungers and tables for outside and inside use are sure to please.

POSILOCK

Ready made up or combined individually, POSILOCK offers creative opportunities for interior design: from private homes through shopfitting up to decorative elements.



Specials

The know-how of the experts from Carl Stahl allows development of special parts, manufacturing or turned and stainless steel cast parts according to drawings, as well as supply of individual standard parts. Our portfolio for special requirements extends from initial idea to delivery of the finished product.

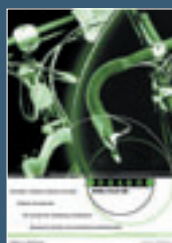
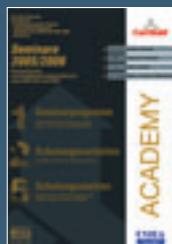
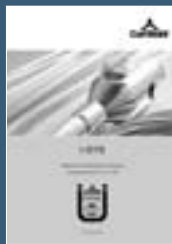

Carl Stahl Product Range



Carl Stahl: Worldwide

Austria

Carl Stahl GmbH
Gewerbepark 660
6870 Bezau
Tel+43/5514-30105
Fax+43/5514-30105-90
bezau@carlstahl.com

Australia

Ronstan International Pty. Ltd.
220 Bay Road
Sandringham
Victoria 3191
Tel+61/3/85990000
Fax+61/3/85990099
ronsmelb@ronstan.com.au

Belgium

Carl Stahl Benelux B.V.
Kleine Tocht 5
NL-1507 CB Zaandam
Tel+31/75/6318536
Fax+31/75/6310968
info@carlstahl.nl

Brazil

Carl Stahl Acos, Cabos e Sistema Ltda.
Rua dos Sorocabanos 844
04202-001 Sao Paulo
Tel+55/11/69147100
Fax+55/11/69141129
carlstahl@carlstahl.com.br

Czech Republic

Carl Stahl & spol, s.r.o.
Bozanovska 2098
19300 Praha 9
Tel+42/2/81925977
Fax+42/2/81920172
hadac@atlas.cz

Denmark

Carl Stahl A/S
Karetmagervej 19
7000 Fredericia
Tel+45/76/240234
Fax+45/76/240345
salg@carlstahl.dk

Finland

Carl Stahl Oy
PL 63
20321 Turku
Tel+358/2/2750060
Fax+358/40/8824485
myynti@carlstahl.com

France

Carl Stahl Sarl.
43, rue des Tuileries
67460 Souffelweyersheim
Tel+33/3/88183700
Fax+33/3/88184704
carlstahlfr@carlstahl.fr

Germany

Carl Stahl GmbH
Postweg 41
73079 Süssen
Tel+49/7162-4007-0
Fax+49/7162-4007-968
cablevision@carlstahl.com

Great Britain

Carl Stahl Evita Ltd.
Goldthorpe Ind. Estate
Commercial Road
Goldthorpe
S63 9 BL Rotherham
Tel+44/1709/899910
Fax+44/1709/899922
cablevision@carlstahlevita.co.uk

Hongkong/China

Widevelop Ltd.
Room 602, 6/7 Westlands Centre
20 Westlands Road
Hongkong-Quarry Bay
Tel+852/24/159966
Fax+852/24/159842
sales@widevelop.hk

Hungary

Carl Stahl Hungária Kft
Honvéd u. 39
2330 Dunaharaszti
Tel+36/24/491452
Fax+36/24/491452
janosgill@carlstahl.hu

India

New Era Industries
51 Adhchini, Sri Aurobindo Marg.
110017 New Delhi
Tel+91/11/6854673
Fax+91/11/6863573
newera@touchtelindia.net

Netherlands

Carl Stahl Benelux B.V.
Kleine Tocht 5
1507 CB Zaandam
Tel+31/75/6318536
Fax+31/75/6310968
info@carlstahl.nl

Norway

Carl Stahl AS
Postboks 314, Nesttun
5853 Bergen
Tel+47/55/926360
Fax+47/55/926370
carlstahl@carlstahl.no

Carl Stahl AS
Branch Office
Postboks 56
3138 Skallestad
Tel+47/33/304715
Fax+47/33/304716
jan-erik.jansson@carlstahl.no

Poland

Carl Stahl Techservice Sp.z.o.o
P.O. Box 143
74404 Cychry
Tel+48/95/7288885
Fax+48/95/7288886
biuro@techservice.com.pl

Republic of Ireland

Carl Stahl Evita Ltd.
Goldthorpe Ind. Estate
Commercial Road I Goldthorpe
S63 9 BL Rotherham
Tel+44/1709/899910
Fax+44/1709/899922
cablevision@carlstahlevita.co.uk

South Africa

GKD-Buismet (Pty.)
P.O.Box 6176
Greenhills 1767
Tel+27/11/4124770
Fax+27/11/4124823
gkdrsa@gkd.co.za

Switzerland

Carl Stahl AG
Stachelhofstrasse 12
8854 Siebnen
Tel+41/55-45050-00
Fax+41/55-45050-05
eduard.haegi@carlstahl.ch

Taiwan

Chung Tai Metal Co.
1F. no.16, Lane 25
Lin Yi Street I Taipei
Tel+886/2/23519569
Fax+886/2/23944736
ctai.metal@msa.hinet.net

United Arab Emirates

Carl Stahl Middle East LLC.
P.O. Box 26607
Dubai - UAE
Tel+971/4/3244077
Fax+971/4/3243116
stahl@emirates.net.ae

USA

Carl Stahl Decorcable Innovations LLC.
660 W. Randolph St.
Chicago, IL 60661
Tel+1/800/4446271
Fax+1/312/4741789
sales@decorcable.com

Published by

Carl Stahl GmbH, Suessen

Coordination

Thomas Krieger, Carl Stahl

Art direction and editorial staff

Büro Blank Communication Services, Holzgerlingen

Photos

Products and applications: Kuhnle + Knödler, Radolfzell
Small products in the tables: Axel Waldecker, Murr

Projects

Page 6-9

Stiftskirche, Stuttgart

Collaboration: Carl Stahl

Photos: Hans-Georg Esch, Hennef/Sieg

Page 86-90

Esch-Fonds, Cologne

Photos: Michael Reisch, Düsseldorf

Production

L&N, Waiblingen

Exclusion of liability

All information is given with the intention of accuracy and completeness. Carl Stahl would appreciate any information regarding errors or missing items. All information in this catalogue is valid at the time of printing. The right is retained to make changes related to continuous improvement of the product range or errors.

Copyright

The catalogue is the intellectual property of Carl Stahl GmbH. Carl Stahl GmbH expressly retains rights of ownership and copyright with regard to the information in the catalogue. Reprinting and reproduction of the text, including in part, is only permitted with the prior written permission of Carl Stahl GmbH.

© 2006

Carl Stahl GmbH

Postweg 41 | 73079 Suessen | Germany

www.carlstahl.com | info@carlstahl.com